

36" Video Production Camera Cart

摄影器材导演车 (36寸)

Operating Instruction | 操作指引



WE ARE HERE FOR YOU
服务与支持



ETICHETTATURA AMBIENTALE
ENVIRONMENTAL LABELING

- Thank you for purchasing SmallRig's product.
感谢您购买 SmallRig 产品。
- Please read this Operating Instruction carefully.
使用本产品之前，请仔细阅读操作指引。
- Please follow the safety warnings.
请注意所有警告提示并遵循使用操作指引的所有指令。

Product Details | 产品介绍

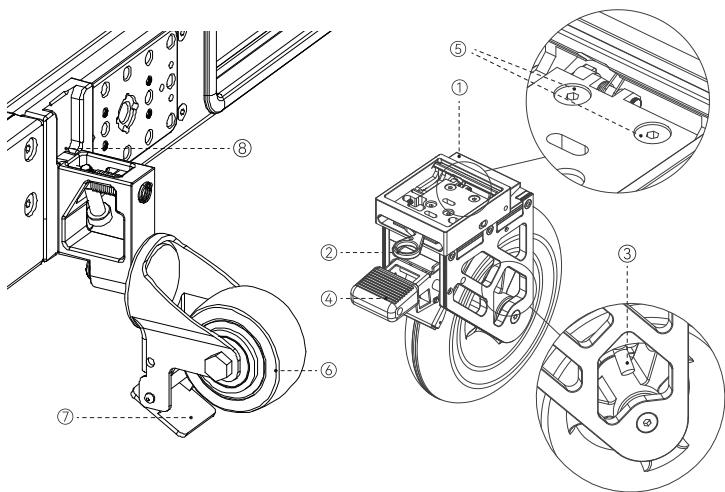

① Caster Quick Release Mount- Press Unlock Button
轮子快拆接口-按压解锁按钮

④ Positive Lock (8" Caster)
脚踏刹车锁

⑦ Positive Lock (Small Caster)
脚踏刹车锁

② Caster Quick Release Mount- Red Lever
轮子快拆接口-红色扳扣

⑤ Fixed-to-Swivel Screws
定向转万向螺丝

⑧ Caster Quick Release Mount
小轮快拆接口

③ Valve Stem
充气阀门

⑥ Small Caster
小轮

Product Details | 产品介绍

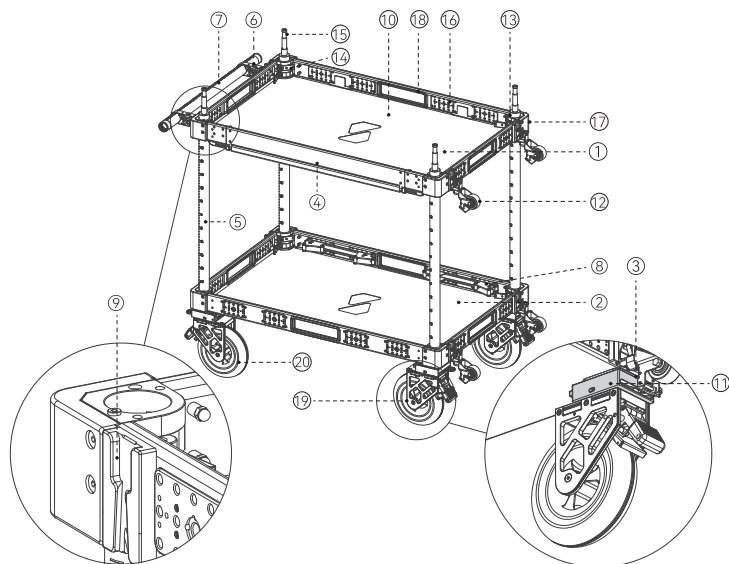

① Top Deck
(Fixed Height, 4-Sided)
固定高度的四面搁板-上层

② Bottom Deck
(Fixed Height, 4-Sided)
固定高度的四面搁板-下层

③ Quick Release Caster Plate
轮子快拆接口

④ Hinged Sideboard
铰链开合板

⑤ Riser with Scale Marks
带刻度支腿

⑥ Quick Release Handrail
快拆扶手

⑦ 35mm Rod
35mm 管

⑧ Caster Retention Bracket
轮子约束器

⑨ Quick Release Mount Plate
快拆安装座

⑩ Deck Pad
鼠标垫

⑪ Quick Release
Caster Plate
轮子快拆接口

⑫ Small Caster
小轮

⑬ 35mm Rod Clamp
35mm 管夹

⑭ 35mm Rod Clamp
Rock Wrench
35mm 管夹锁紧扳手

⑮ 5/8" Baby Pin Mount
5/8" 插销接口

⑯ Cheese Plate
螺纹孔安装板

⑰ Protective Corner
防撞角

⑱ Grip Slot
握把槽

⑲ 8" Detachable
Swivel Caster
8英寸万向轮

⑳ 8" Detachable
Fixed Caster
8英寸定向轮

Safety Guidelines | 注意事项

1. Do not use the product underwater, in extreme temperatures (e.g., freezing or direct heat), corrosive environments, or excessive dust. Dry metal parts immediately after liquid contact to prevent corrosion.

请勿在水下、极端温度（如冷冻或高温暴晒）、强腐蚀性或多尘环境中使用本产品。金属部件接触液体后请立即擦干，避免长期接触水分导致锈蚀。

2. Do not exceed the maximum weight capacity indicated on the product. Overloading risks structural failure, deformation, or accidental drops.

请勿超过产品标注的最大承重限制。超载可能导致结构变形、断裂或意外跌落设备。

3. Clean surfaces with a dry, soft cloth. Avoid chemicals like alcohol or solvents. Ensure dry and ventilated conditions for long-term storage.

使用干燥软布清洁表面，避免酒精、溶剂等化学试剂直接接触产品。长期存放前请确保环境干燥通风。

4. Do not modify the product (e.g., drilling, cutting)—this compromises structural integrity and increases drop risks.

请勿自行对产品进行钻孔、切割或改造，以免破坏结构强度，增加设备跌落风险。

5. Stop use immediately if you notice deformation, unusual noises, or loose components, and contact support.

若产品出现变形、异响或部件松动，请立即停止使用并联系客服。

In the Box | 包装清单

Cart (Fixed Height 4-Sided Deck × 2, Riser × 4) 导演车（带固定高度的四面挡板 × 2，支腿 × 4）	× 1	Quick Release Small Caster 快拆万向小轮	× 4
Quick Release Handrail 快拆扶手	× 1	Caster Storage Bag 车轮收纳袋	× 1
8" Detachable Swivel Caster with Positive Lock 可拆卸带脚刹的8英寸万向车轮	× 2	Skirt 围挡布	× 1
8" Detachable Fixed Caster 可拆卸的8英寸定向车轮	× 2	Operating Instruction 操作指引	× 1

Cart Installation | 车体安装步骤

Steps 1 | 步骤一

- Unscrew the four 5/8" Baby Pin Mounts counterclockwise and set them aside.
- 逆时针拆下四个 5/8" 插销接口，备用。

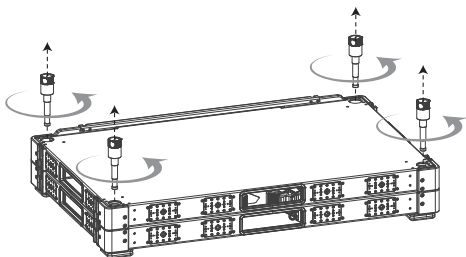

Steps 2 | 步骤二

- Hold both Handle Slots, unfold the Top Deck.
- 握住上层搁板两侧握把，打开搁板。

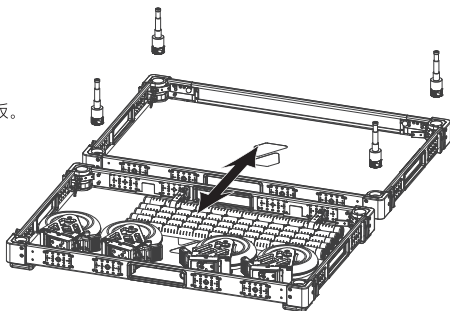

Steps 3 | 步骤三

- Take out the Skirt, Caster Bag, and Deck Pads.
- 取出围挡布、收纳袋、鼠标垫，放置一旁。

Steps 4 | 步骤四

- Press the Caster Retention Bracket Lock to release four Casters.
- 按压轮子固定器锁扣，取出四个大轮。

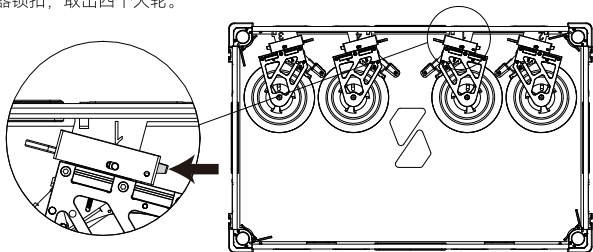

Steps 5 | 步骤五

- Position the bottom deck upright, match numbered labels and install casters. (Make sure the fixed and swivel casters are positioned on the correct sides.)
- 竖起下层搁板，对号安装轮子。
(注意检查定向轮或者万向轮是否在同侧。)

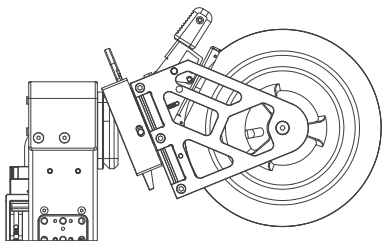

Steps 6 | 步骤六

- Push four casters into Quick Release Mounts, lock with Red Levers.
- 插入快拆接口，按红色扳扣方向锁紧。

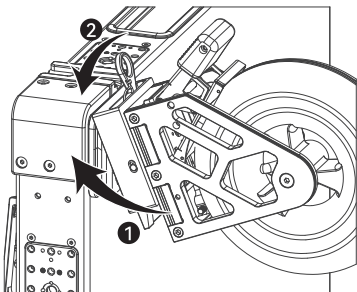

Steps 7 | 步骤七

- Insert four Risers, lock with Red Lever.
- 插入四个支腿，锁紧。

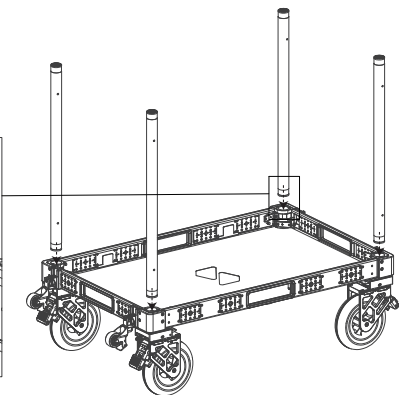
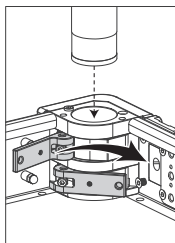

Steps 8 | 步骤八

- Align and install the Top Deck, secure all corners.
- 安装上层搁板，锁紧四角。

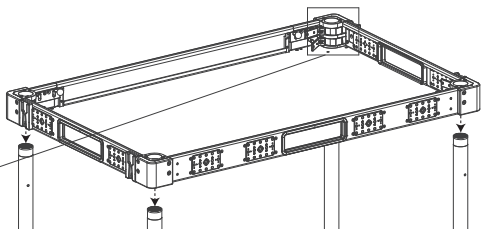
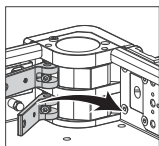

Steps 9 | 步骤九

- Insert the Quick Release Handrail upward into the Quick Release Mount Plate on the swivel-caster side.
- 取出围挡布中的扶手杆，找到万向轮一侧，从下往上对准快拆安装座，安装扶手杆即可。

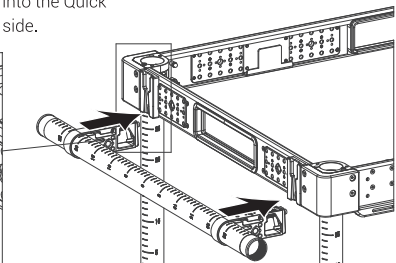
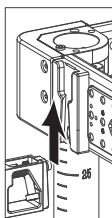

Steps 10 | 步骤十

- Install four 5/8" Mounts into top corners, and lock with red levers.
- 将4个5/8" 插销接口插入上层板的四角，并红色扳扣锁紧，作为安装接口使用。

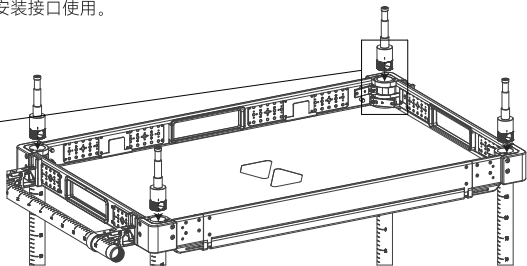
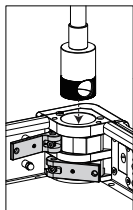

Steps 11 | 步骤十一

- Place Deck Pads, assembly complete.
- 铺上鼠标垫，完成组装。

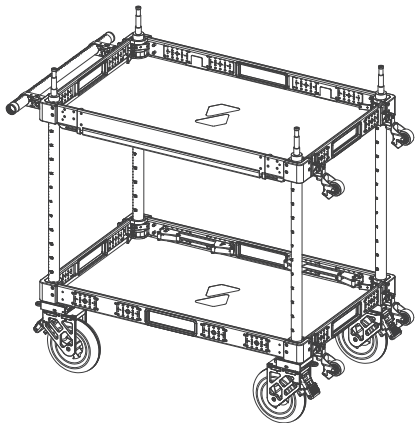

Skirt Installation | 导演车围挡布安装步骤

Steps 1 | 步骤一

- Stand by the Hinged Sideboard and attach the Skirt surround the risers.
- 请站在开合板一侧，取出围挡布，将其环绕包围桌腿。

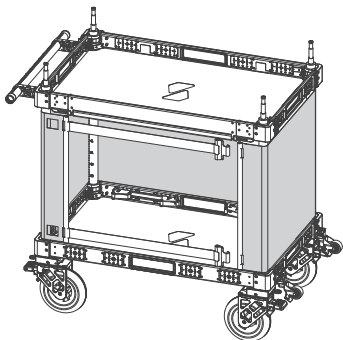

Steps 2 | 步骤二

- Drape the skirt around the outside and pull the elastic straps and hook them securely to the other ends.
- 围挡布覆盖在外侧，拉伸皮筋并将挂钩安装在另一端缺口处。

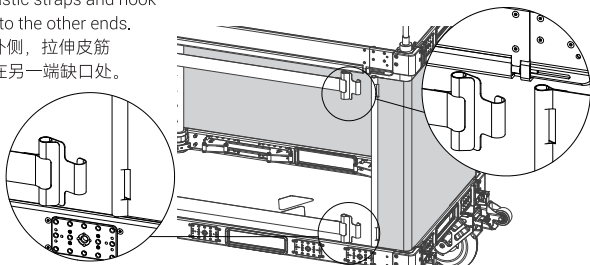

Steps 3 | 步骤三

- Smooth out any wrinkles to finish installation.
- 手动平整围挡布褶皱处，即可完成围挡布的安装。

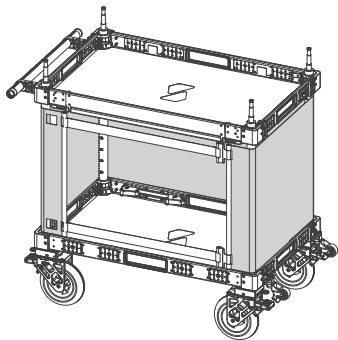

Suitcase Mode Setup | 导演车-行李箱状态安装步骤

Steps 1 | 步骤一

- Remove the Handrail by pressing inward on the lock levers and pulling downward. Store it inside the Skirt storage compartment.
- 拆卸扶手: 双手同时向里解锁扶手的扳扣, 同时向下取出扶手杆, 放置在围挡布的收纳槽中。

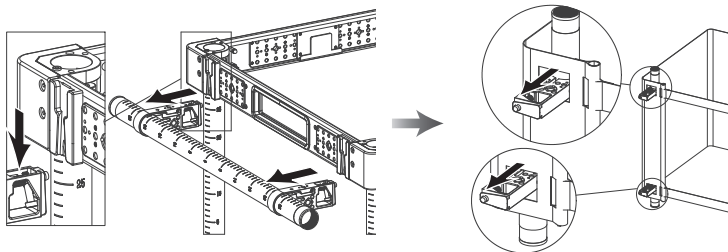

Steps 2 | 步骤二

- Unlock the Top Deck using the Red Corner Levers, then remove it.
- 拆卸上层板: 解锁搁板四个角的红色转角扳扣, 取出上层板。

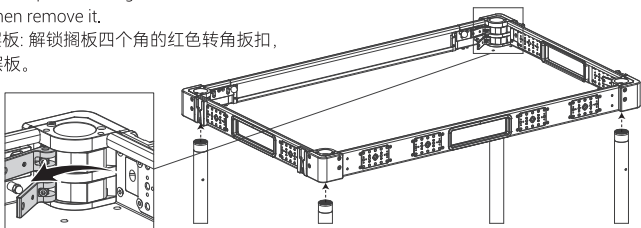

Steps 3 | 步骤三

- Pull out the four Risers and store them inside the Skirt storage compartment.
- 拆卸支腿: 向上拔出4个支腿, 将其放置在围挡布的收纳槽中。

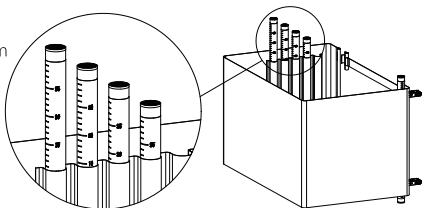

Steps 4 | 步骤四

- To remove each caster, release the Red Lever and press the Unlock Button on the Caster Quick Release Mount, then pull out.
- 拆卸轮子: 将下层板竖起来, 先解锁红色扳扣, 然后向下按压解锁按钮, 取出轮子, 其余轮子拆卸步骤同上。

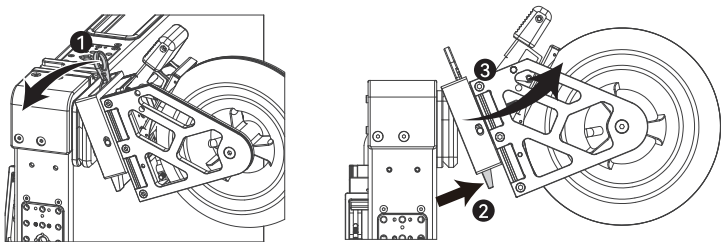

Steps 5 | 步骤五

- Reinsert the casters into the Caster Retention Bracket according to the numbered slots, making sure the Positive Locks face outward.
- 固定轮子: 将4个轮子按照编号顺序和脚踏刹车的方向标志按压安装在约束器上。

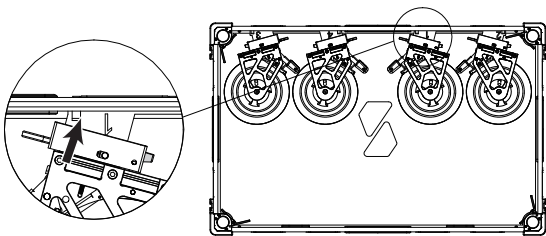

Steps 6 | 步骤六

- Flip the Top Deck upside down onto the Bottom Deck, align the four corners and secure using the 5/8" Baby Pin Mounts. Tighten with a Rock Wrench if needed.
- 固定搁板: 上层板在上, 反过来对准下层板的四个角的定位柱, 并用4个5/8" 插销接口固定两层板, 可用扳手加固。

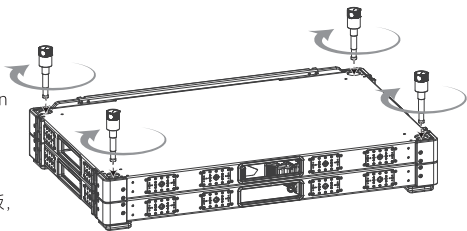

Steps 7 | 步骤七

- Align the Small Casters with the Quick Release Mounts on the same side of both decks, and press in following the arrow direction.
- 安装小轮: 将小轮对准上下层板同侧的快拆安装座上, 按箭头方向安装即可固定。

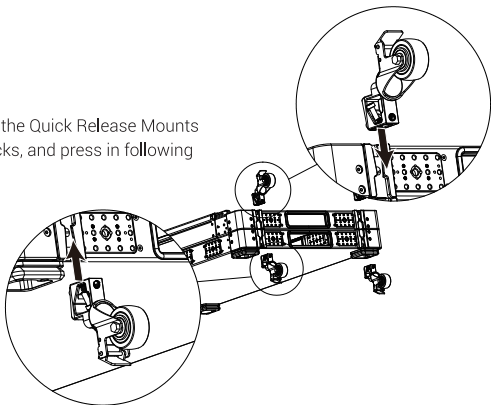

Steps 8 | 步骤八

- Hold the Handle Slot, release the Small Caster positive locks, and push the cart.
- 推行- 手握搁板一侧的握把, 向前推行。(注意解锁小轮刹车装置, 否则无法顺畅推行)



Specifications | 产品参数

Product Dimensions (Assembled) 产品尺寸 (组装状态)	38.6 × 24.4 × 38.0in 98.0 × 62.0 × 96.6cm
Product Dimensions (Collasped) 产品尺寸 (收纳状态)	38.6 × 24.4 × 6.8in 98.0 × 62.0 × 17.2cm
Product Weight 产品重量	70.5lb / 32.0kg
Package Weight 包装重量	77.2lb / 35.0kg
Material (s) 主要材质	Aluminum Alloy, Stainless Steel, Nylon 铝合金、不锈钢、尼龙
Payload Capacity 承重	551.0lb / 250.0kg
Top Deck Payload Capacity 上层板承重	220.5lb / 100.0kg
Bottom Deck Payload Capacity 下层板承重	330.6lb / 150.0kg
A Total Height 总高度	38.0in / 96.6cm
B Work Surface Height 工作台高度	35.3in / 89.6cm
C Height Between Shelves 上层板和下层板之间的桌面距离	25.3in / 64.2cm
D Clearance Between Bottom Deck and Top Deck 上层板和下层板之间的间隔距离	25.0in / 63.5cm
E Ground Clearance 离地面高度	9.8in / 24.8cm
F Deck Area 搁板面积	36.5 × 22.6in / 92.8 × 57.4cm
G Bottom Deck Volume 下层容量	36.5 × 22.6 × 25.0in 92.8 × 57.4 × 63.5cm

* Specifications subject to change without prior notice. Please refer to the physical product for the most up-to-date information.

技术参数如有改动，以实物为准，恕不另行通知。

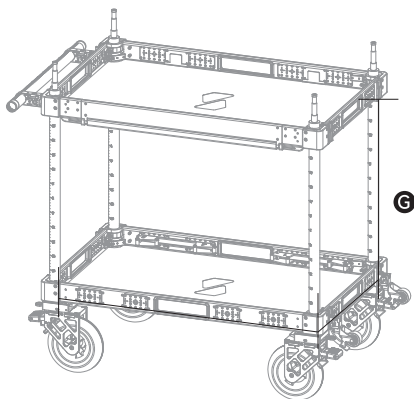
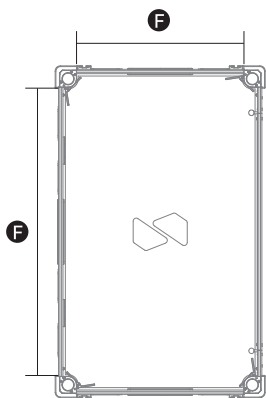
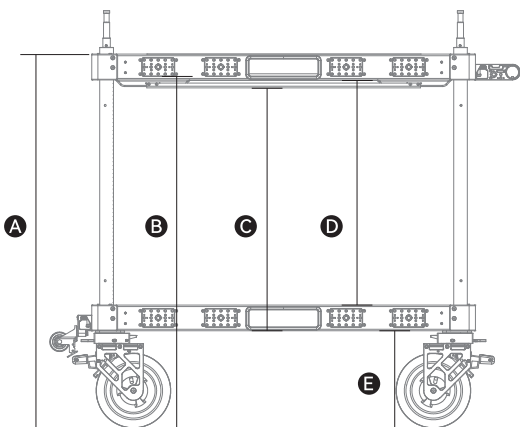

Service & Warranty

Please keep your original receipt and guarantee card. Be sure the dealer has written on it the date of purchase and SN of the product. These are required for warranty service.

After-sale Warranty Terms

SmallRig products are entitled to warranty services as of the date of payment.

- Electronic products (except V mount battery): 1-year warranty.
- V mount battery: 2-year warranty.
- Non-electronic products: 2-year warranty.

Note: In case of any conflict between our warranty period policy and applicable laws and regulations of the country / region where the products are sold, the latter shall prevail.

This Warranty Does Not Cover

1. If users fail to adhere to the "Operating Instruction" or any "Warnings" stated in the user manual, resulting in a quality failure, it falls outside the scope of warranty coverage.
2. The product identification or SN label is removed or defaced in any way.
3. Product damage caused by problems not attributable to the quality of the products such as improper use of the products.
4. Product damage caused by unauthorized modification, disassembly, repair and other acts.
5. Product damage caused by fires, floods, lightning and other force majeure factors.

Warranty Mode

• For the products within the scope of warranty, SmallRig will repair or replace them on the basis of specific failures; the repaired / replaced products / parts are entitled to the remaining part of the original warranty period.

Contact Information

- You're advised to contact the online customer service personnel of corresponding shopping platform and submit a repair service application.
 - You may also apply for repair service through SmallRig's service email.
- Service Email: support@smallrig.com

保修条款

请保留您的原始购买单据及保修卡,同时包含您的购买日期、产品序列号等,这些资料质保服务时均需要提供。

售后质保条款

SmallRig产品自下单付款之日起享有质保服务。

· 电子产品 (除V口电池): 1年质保。

· V口电池: 2年质保。

· 非电子产品: 2年质保。

注: 若销售地国家或地区的适用法律法规有冲突的,以销售地国家或地区有关质保期的法律法规为准。

质保无效说明

1. 当用户违反操作指引或用户手册中“重要提示”任何一条导致的质量失效,不在质保范围内。
2. 产品序列号标识已经被撕毁或无法辨识,不在质保范围。
3. 产品使用不当等非产品本身质量问题,而造成的产品损坏,不在质保范围。
4. 非官方指导的私自改装、拆解、维修等行为而造成的损坏,不在质保范围。
5. 因火灾、水灾、雷击等不可抗力造成的产品损坏,不在质保范围。

维修方式

· 属于质保范围的,SmallRig 根据产品具体的故障对产品进行维修或更换; 维修后的产品 / 部件享受原有保修期的剩余时长。

联系方式

- 建议您优先前往相应购买平台联系在线客服,提出产品维修申请。
- 您也可以通过 SmallRig 服务邮箱申请维修服务。

服务邮箱: support@smallrig.com

Guarantee Card | 保修卡

ID No. ID 编号	
Item Name 产品名称	
Purchase Date 购买日期	
User Name 用户姓名	
Mobile 用户电话	
Address 用户地址	
Receipt 购买单据	

Manufacturer Email: support@smallrig.com

Manufacturer: Shenzhen Legi Innovation Co., Ltd.

Add: Rooms 101, 701, 901, Building 4, Gonglianfuji Innovation Park, No. 58, Ping'an Road, Dafu Community, Guanlan Street, Longhua District, Shenzhen, Guangdong, China.

制造商：深圳市乐其创新股份有限公司

地址: 中国广东省深圳市龙华区观澜街道大富社区平安路58号共联富基创新园4栋101、701、901

Consignor: Shenzhen LC Co., Ltd.

Add: Room 201, Building 4, Gonglianfuji Innovation Park, No. 58, Ping'an Road, Dafu Community, Guanlan Street, Longhua District, Shenzhen, Guangdong, China.

委托商: 深圳市乐长科技有限公司

地址: 中国广东省深圳市龙华区观澜街道大富社区平安路58号共联富基创新园4栋201

EC	REP	GAVIMOSA CONSULTORIA, SOCIEDAD LIMITADA, CASTELLANA 9144, 28046 Madrid, compliance.gavimosa@outlook.com	UK	REP	Sea&Mew Accounting Ltd, Electric Avenue Vision 25, London, Enfield EN3 7GD, info@seamew.net
----	-----	---	----	-----	---

执行标准: GB/T 26572-2011

LO-B794-18



RoHS



Made in China
中国制造

Séparez les éléments avant de trier