

# SmallRig | TRANSFORMERS



## 「迅鹰」快拆拓展框套件

适用于索尼 Alpha 7R V / 7 IV / 7S III，进阶版  
(大黄蜂系列)

操作指引

感谢您购买 SmallRig 产品。

使用本产品之前，请仔细阅读操作指引。

请注意所有警告提示并遵循使用操作指引的所有指令。

## 产品参数

|      |                                           |
|------|-------------------------------------------|
| 兼容性  | 索尼 Alpha 7R V / Alpha 7 IV / Alpha 7S III |
| 产品尺寸 | 215.0 × 266.3 × 137.7mm                   |
| 产品重量 | 660.0 ± 5.0g                              |
| 材质   | 铝合金、不锈钢                                   |

## 包装清单

|           |     |         |     |
|-----------|-----|---------|-----|
| ① 拓展框     | × 1 | ⑤ 监视器支架 | × 1 |
| ② HDMI线夹  | × 1 | ⑥ 六角扳手  | × 2 |
| ③ 滑槽上手提   | × 1 | ⑦ 操作指引  | × 1 |
| ④ 旋转滑槽侧手柄 | × 1 |         |     |

# 产品介绍

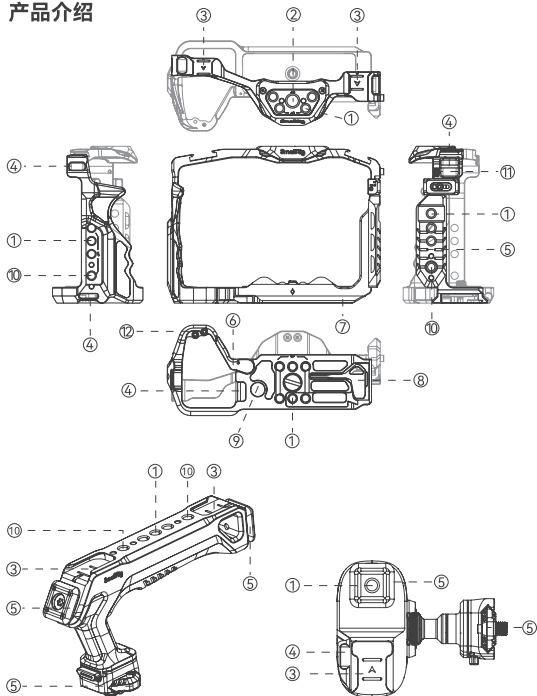

① 1/4"-20 螺纹孔

④ 手腕带 / 肩带接口

⑦ 迅鹰H38阿卡规格快装板

⑩ 1/4"-20 定位孔

② 阿莱定位孔

⑤ 迅鹰H21 滑条

⑧ 双头扳手

⑪ M2.5 螺丝

③ 迅鹰H18冷靴

⑥ 开合扳手

⑨ QD 接口

⑫ 防偏转销钉

## 拓展框安装步骤

1. 取下相机镜头和左侧肩带挂钩，然后将相机从后往前放入拓展框。

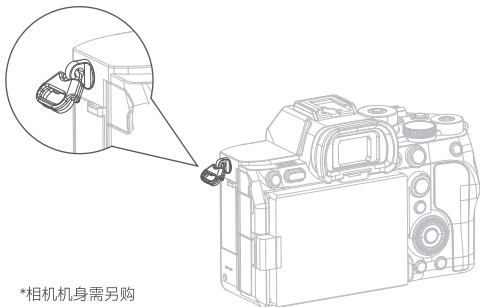

2. 使用双头扳手固定底部 1/4"-20 螺丝。

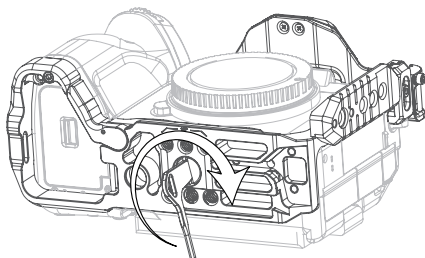



3. 将底部防偏转销取下安装至对应位置；将拓展框右侧M2.5螺丝取下，并穿过右侧肩带挂钩孔锁紧至拓展框。

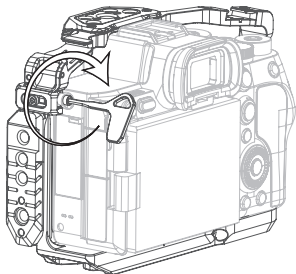
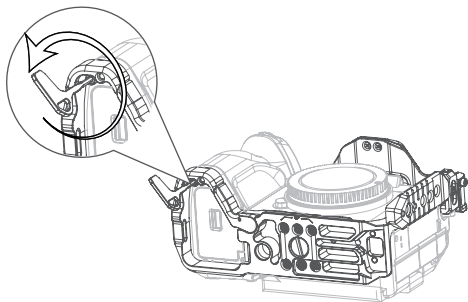

\*相机机身需另购

## HDMI 线夹安装步骤

1. 打开相机HDMI保护盖，将线夹安装至拓展框对应位置（请勿完全锁紧）。插入HDMI线后锁紧线夹。

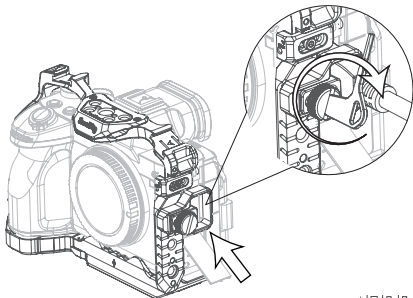

\*相机机身需另购

## 滑槽上手提安装步骤

1. 将滑条固定至拓展框顶部的阿莱定位孔，按压解锁按钮将滑槽上手提滑入滑条。

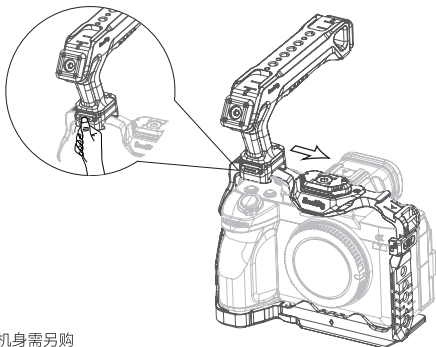

\*相机机身需另购

## 旋转滑槽侧手柄安装步骤

1. 按压解锁按钮将滑槽旋转侧手柄滑入拓展框左侧滑条。

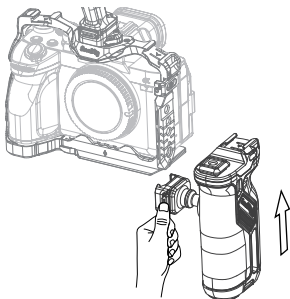

\*相机机身需另购

## 监视器支架安装步骤

1. 按压解锁按钮将监视器支架滑入至冷靴。

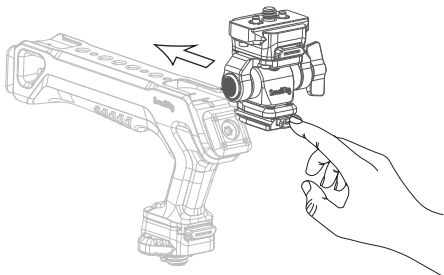

## 保修条款

请保留您的原始购买单据及保修卡,同时包含您的购买日期、产品序列号等,这些资料质保服务时均需要提供。

### 售后质保条款

SmallRig产品自下单付款之日起享有质保服务。

- 电子产品(除V口电池): 1年质保。
- V口电池: 2年质保。
- 非电子产品: 2年质保。

注:若销售地国家或地区的适用法律法规有冲突的,以销售地国家或地区有关质保期的法律法规为准。

### 质保无效说明

1. 当用户违反操作指引或用户手册中“重要提示”任何一条导致的质量失效,不在质保范围内。
2. 产品序列号标识已经被撕毁或无法辨识,不在质保范围。
3. 产品使用不当等非产品本身质量问题,而造成的产品损坏,不在质保范围。
4. 非官方指导的私自改装、拆解、维修等行为而造成的损坏,不在质保范围。
5. 因火灾、水灾、雷击等不可抗力造成的产品损坏,不在质保范围。

### 维修方式

- 属于质保范围的,SmallRig根据产品具体的故障对产品进行维修或更换;维修后的产品/部件享受原有保修期的剩余时长。

### 联系方式

- 建议您优先前往相应购买平台联系在线客服,提出产品维修申请。
- 您也可以通过 SmallRig 服务邮箱申请维修服务。

服务邮箱:support@smallrig.com

## 保修卡

|       |  |
|-------|--|
| ID 编号 |  |
| 产品名称  |  |
| 购买日期  |  |
| 用户姓名  |  |
| 用户电话  |  |
| 用户地址  |  |
| 购买单据  |  |

执行标准: GB/T 26572-2011

制造商: 深圳市乐其创新股份有限公司

地址: 中国广东省深圳市龙华区观澜街道大富社区平安路58号共联富基创新园  
4栋101、701、901

委托商: 深圳市乐长科技有限公司

地址: 中国广东省深圳市龙华区观澜街道大富社区平安路58号共联富基创新园  
4栋201

**RoHS**

**CE**



FR

**LE TRI  
+ FACILE**



Boîte 1 Papier 5

LQ-P1530-18

Licensed By:

*Séparez les éléments avant de trier*

Made in China



©2025 Hasbro. ©2025 DreamWorks LLC and  
Paramount Pictures Corporation.



# SmallRig | TRANSFORMERS



## "HawkLock" Quick Release Cage Kit

for Sony Alpha 7R V / Alpha 7 IV / Alpha 7S III, Advanced Edition  
(BumbleBee Edition)

Operating Instruction

- Thank you for purchasing SmallRig's product.
- Please read this Operating Instruction carefully.
- Please follow the safety warnings.

## Specifications

|                    |                                              |
|--------------------|----------------------------------------------|
| Compatibility      | Sony Alpha 7R V / Alpha 7 IV / Alpha 7S III  |
| Product Dimensions | 215.0 × 266.3 × 137.7mm / 8.5 × 10.5 × 5.4in |
| Product Weight     | 660.0 ± 5.0g / 23.3 ± 0.2oz                  |
| Material(s)        | Aluminum Alloy, Stainless Steel              |

## In the Box

|                                        |     |
|----------------------------------------|-----|
| ① Cage                                 | × 1 |
| ② HDMI Cable Clamp                     | × 1 |
| ③ Top Handle with NATO Clamp           | × 1 |
| ④ Rotating Side Handle with NATO Clamp | × 1 |
| ⑤ Monitor Mount                        | × 1 |
| ⑥ Allen Wrench                         | × 2 |
| ⑦ Operating Instruction                | × 1 |

## Product Details

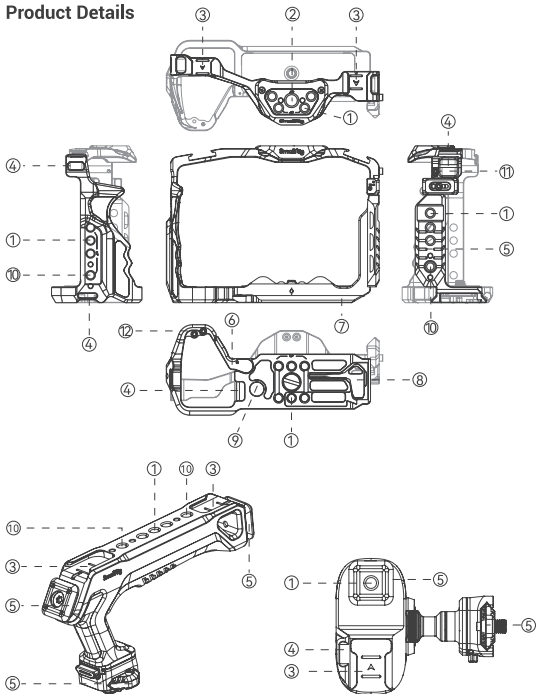

① 1/4"-20 Threaded Hole

② ARRI 3/8"-16 Locating Hole

③ HawkLock H18 Cold Shoe Mount

④ Strap Slot

⑤ HawkLock H21 NATO Rail

⑥ Hinged Door

⑦ HawkLock H38 Arca-Swiss Quick Release Plate

⑧ Dual-Head Wrench

⑨ QD Socket

⑩ 1/4"-20 Locating Hole

⑪ M2.5 Screw

⑫ Anti-Twist Pin



## Cage Installation

1. Remove the camera lens and the shoulder strap hooks on left side.  
Put the camera into the cage from back

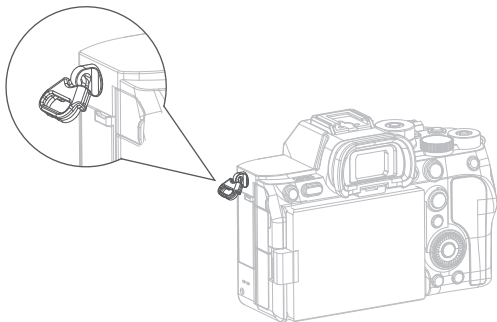

2. Use the dual-head wrench to lock the bottom 1/4"-20 screw

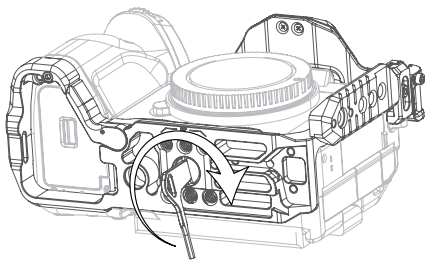

\* The package does not  
include the camera

3. Remove the bottom anti-twist pin and install it in the corresponding position. Remove the M2.5 screw on the right side of the cage and lock it through the right strap hole to the cage

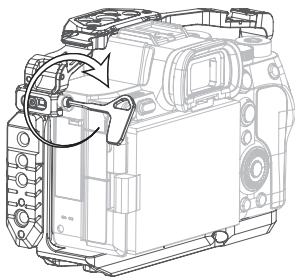
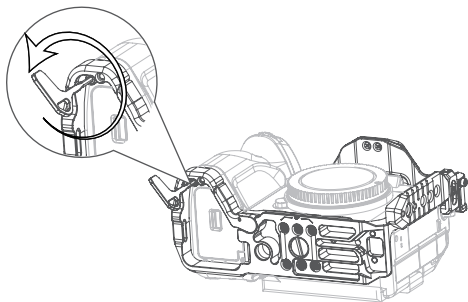

\* The package does not include the camera

## Installation of HDMI Cable Clamp

1. Open the HDMI cover and install the cable clamp to the corresponding position on the cage (do not lock it completely). Lock the cable clamp after inserting the HDMI cable

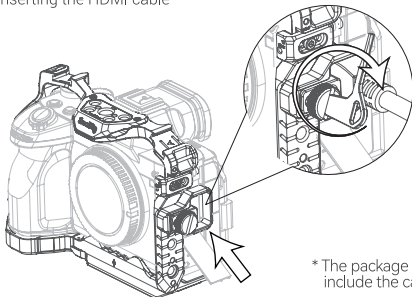

\* The package does not include the camera

## Installation of Top Handle with NATO Clamp

1. Secure the NATO rail to the ARRI 3/8"-16 locating hole on the top of the cage, press the unlock button to slide the top handle with NATO clamp into the NATO rail

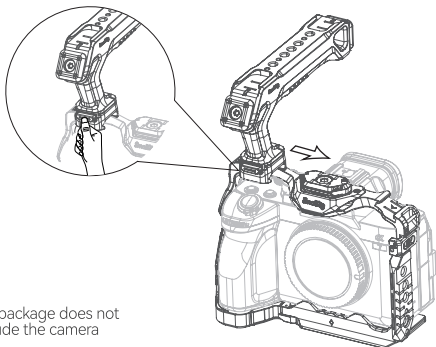

\* The package does not include the camera

## Installation of Rotating Side Handle with NATO Clamp

1. Press the unlock button to slide the rotating side handle with NATO clamp into the NATO rail on the left side of the cage

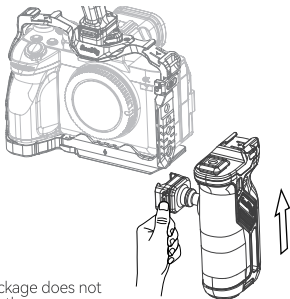

\* The package does not include the camera

## Installation of Monitor Mount

1. Press the unlock button to slide the monitor mount into the cold shoe

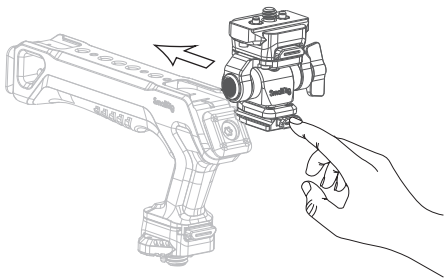

# Service & Warranty

---

Please keep your original receipt and guarantee card. Be sure the dealer has written on it the date of purchase and SN of the product. These are required for warranty service.

## After-sale Warranty Terms

SmallRig products are entitled to warranty services as of the date of payment.

- Electronic products (except V mount battery): 1-year warranty.
- V mount battery: 2-year warranty.
- Non-electronic products: 2-year warranty.

Note: In case of any conflict between our warranty period policy and applicable laws and regulations of the country / region where the products are sold, the latter shall prevail.

## This Warranty Does Not Cover

1. If users fail to adhere to the "Operating Instruction" or any "Warnings" stated in the user manual, resulting in a quality failure, it falls outside the scope of warranty coverage.
2. The product identification or SN label is removed or defaced in any way.
3. Product damage caused by problems not attributable to the quality of the products such as improper use of the products.
4. Product damage caused by unauthorized modification, disassembly, repair and other acts.
5. Product damage caused by fires, floods, lightning and other force majeure factors.

## Warranty Mode

- For the products within the scope of warranty, SmallRig will repair or replace them on the basis of specific failures; the repaired / replaced products / parts are entitled to the remaining part of the original warranty period.

## Contact Information

- You're advised to contact the online customer service personnel of corresponding shopping platform and submit a repair service application.
- You may also apply for repair service through SmallRig's service email.

Service Email: [support@smallrig.com](mailto:support@smallrig.com)

# Guarantee Card

|               |  |
|---------------|--|
| ID No.        |  |
| Item Name     |  |
| Purchase Date |  |
| User Name     |  |
| Mobile        |  |
| Address       |  |
| Receipt       |  |



WE ARE HERE FOR YOU  
服务与支持



ETICHETTATURA AMBIENTALE  
ENVIRONMENTAL LABELING



GAVIMOSA CONSULTORIA, SOCIEDAD LIMITADA,  
CASTELLANA 9144, 28046 Madrid,  
compliance.gavimosa@outlook.com



Sea&Mew Accounting Ltd,  
Electric Avenue Vision 25, London,  
Enfield EN3 7GD, info@seamew.net

Manufacturer Email: support@smallrig.com

Manufacturer: Shenzhen Leqi Innovation Co., Ltd.

Add: Rooms 101, 701, 901, Building 4, Gonglianfuji Innovation Park, No. 58, Ping'an Road,  
Dafu Community, Guanlan Street, Longhua District, Shenzhen, Guangdong, China.

Consignor: Shenzhen LC Co., Ltd.

Add: Room 201, Building 4, Gonglianfuji Innovation Park, No. 58, Ping'an Road,  
Dafu Community, Guanlan Street, Longhua District, Shenzhen, Guangdong, China.

**RoHS**



FR

**LE TRI  
+ FACILE**



Boîte 1 Papier 5

LQ-P1530-18

Licensed By:

*Séparez les éléments avant de trier*

Made in China



©2025 Hasbro. ©2025 DreamWorks LLC and  
Paramount Pictures Corporation.

