

SmallRig



HawkLock H21 Quick Release Magic Arm with Ball Head

Operating Instruction

SmallRig HawkLock H21 Quick Release Magic Arm with Ball Heads 4488 is a compact and lightweight gadget with an exclusive patented quick release slider slot. It also features roll pins positioning technology with a self-locking system that enables vertical locking and can bear loads up to 5.5kg / 12.2lbs. With a \varnothing 20mm / 0.8in ball head and 1/4"-20 screws featuring detachable locating pins at both ends, this ball head, when used with SmallRig camera cages 4119B, 3084C, 4088B, and monitors with similar locating hole specifications, effectively prevents equipment deviation, ensuring the safety of the equipment. The thumb lever on the ball allows for extension adjustment, making it easy to adjust to the desired angle. With slots at both ends of the ball head thumb lever, the adjustment range of the ball head is effectively increased, allowing for flexible positioning of the equipment as needed

Safety Guidelines

1. Environment

Do not use the product underwater, in extreme temperatures (e.g., freezing or direct heat), corrosive environments, or excessive dust. Dry metal parts immediately after liquid contact to prevent corrosion.

2. Load Capacity

Do not exceed the maximum weight capacity indicated on the product. Overloading risks structural failure, deformation, or accidental drops.

3. Cleaning & Maintenance

Clean surfaces with a dry, soft cloth. Avoid chemicals like alcohol or solvents. Ensure dry and ventilated conditions for long-term storage.

4. Structural Integrity

Do not modify the product (e.g., drilling, cutting)—this compromises structural integrity and increases drop risks.

5. Malfunctions

Stop use immediately if you notice deformation, unusual noises, or loose components, and contact support.

In the Box

HawkLock H21 Quick Release Magic Arm with Ball Head	× 1
Silicone Ring	× 2
Allen Wrench	× 1

Exclusive QR-Slide Structure

Press the button to flare the pins, slide the rail into the groove, and lock it by releasing the button.

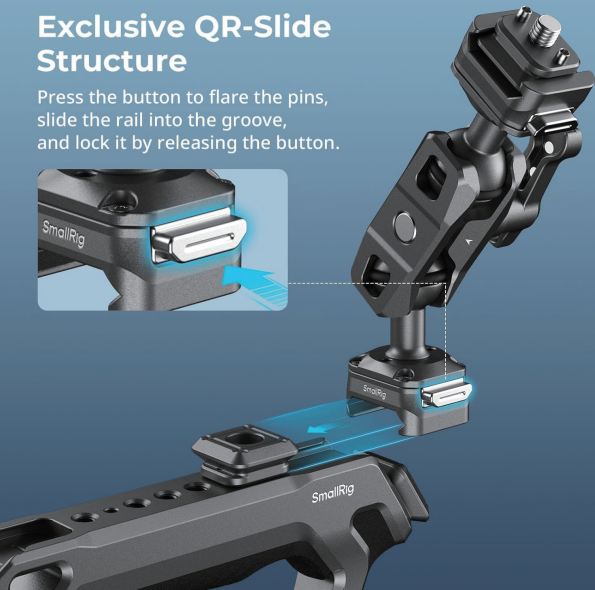

Bi-direction Mounting and Dismounting

Exact alignment and precision Fit



Detachable Anti-Twist Locating pins

The ball head features 1/4"-20 screws and locating pins at both ends.



The locating pins can be detached by allen wrench



Multi-Angle Rotation Ball Heads

The camera magic arm support multi-angle adjustment by releasing the thumb lever.

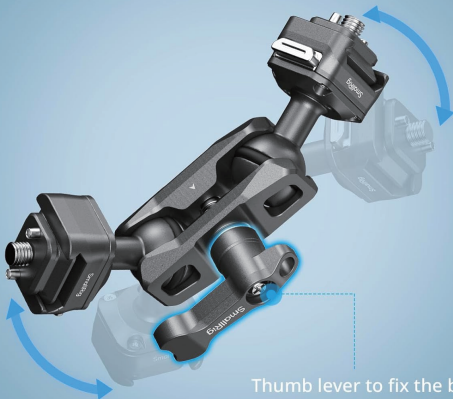

Thumb lever to fix the ball head at fix angle

12.2lbs Payload

The QR magic arm can load up to 5.5kg / 12.2lbs, which can fix your field monitor, LED lights, audio recorders, etc.



Monitors



LED Lights



Camera Cage
(ID: 4119B)



Camera Cage
(ID: 4088B)

5.5kg / 12.1lbs Load-Bearing

5.5kg

Package Includes

HawkLock H21 Quick Release
Magic Arm with Ball Head × 1
Silicone Ring × 2
Allen Wrench × 1

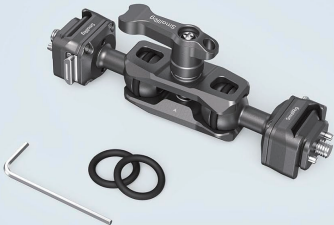

Product Parameters

ID

4488

Product Weight

138.0 ± 5.0g / 4.9 ± 0.2oz

Product Dimension

128.7 × 32.0 × 42.5mm
5.0 × 1.3 × 1.7in

Package Dimension

155.0 × 81.5 × 42.0mm
6.1 × 3.2 × 1.6in

Package Weight

184.0 ± 5.0g / 6.5 ± 0.2oz

Material(s)

Aluminum Alloy, Stainless Steel

Manufacturer Email: support@smallrig.com

Manufacturer: Shenzhen Leqi Innovation Co., Ltd.

Add: Rooms 101, 701, 901, Building 4, Gonglianfuji Innovation Park, No. 58, Ping'an Road,
Dafu Community, Guanlan Street, Longhua District, Shenzhen, Guangdong, China.

Consignor: Shenzhen LC Co., Ltd.

Add: Room 201, Building 4, Gonglianfuji Innovation Park, No. 58, Ping'an Road,
Dafu Community, Guanlan Street, Longhua District, Shenzhen, Guangdong, China.

RoHS



Séparez les éléments avant de trier



Made in China