

# SmallRig

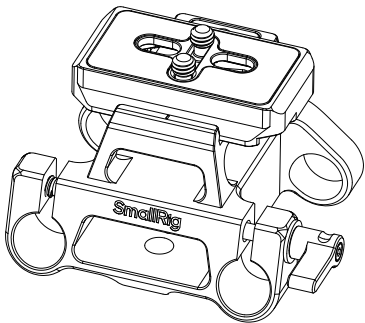

## **Arca-Type Mount Plate Kit with 15mm Dual Rod Clamp**

15mm 双管安装座套件（适配阿卡规格）

Operating Instruction | 操作指引

- Thank you for purchasing SmallRig's product.  
感谢您购买 SmallRig 产品。
- Please read this Operating Instruction carefully.  
使用本产品之前，请仔细阅读操作指引。
- Please follow the safety warnings.  
请注意所有警告提示并遵循使用操作指引的所有指令。

## In the Box / 包装清单

Mount Plate Kit  
安装座套件

× 1

Guarantee Card  
保修卡

× 1

## Interface Introduction / 产品介绍

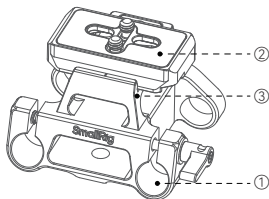

- ① 15mm Rod Clamp  
15mm 管夹
- ② Arca-Swiss Quick Release Plate  
阿卡快装板
- ③ Arca-Swiss Clamp  
阿卡母座
- ④ 1/4"-20 Threaded Hole  
1/4"-20 螺纹孔
- ⑤ 3/8"-16 Threaded Hole  
3/8"-16 螺纹孔

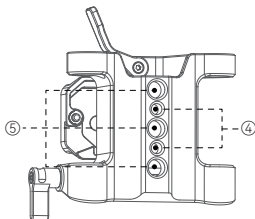

## Installation Instructions / 安装步骤

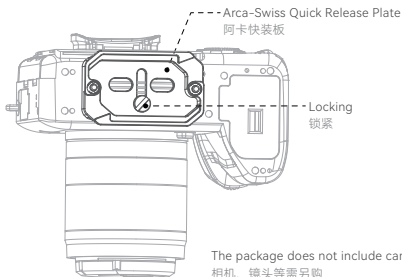
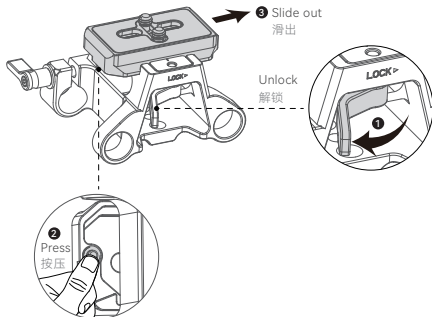

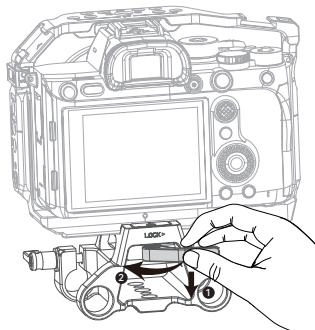
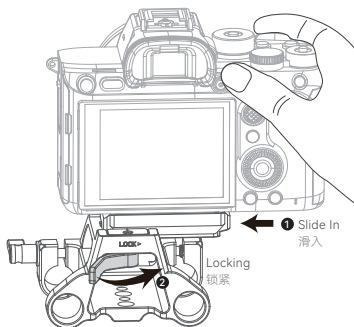

0 0 0 0 0 0 0 0

### Note | 提示

This product is compatible with most Arca-Swiss products. If you experience problems with locking, pull the locking lever down and adjust the lever position to the left to re-lock. If it still does not lock, repeat this procedure until it locks.

此产品兼容大多数阿卡产品。如遇到锁不紧问题，请将锁紧扳扣向下拉，然后向左调节扳扣位置重新进行锁紧。如果还是锁不紧，重复此步骤直至锁紧。

## Specifications / 产品参数

Product Dimensions 产品尺寸	3.1 × 2.7 × 2.3in 80.0 × 68.5 × 59.1mm
Product Weight 产品重量	9.0 ± 0.2oz 173.0 ± 5.0g
Material(s) 主要材质	Aluminum Alloy, Stainless Steel 铝合金、不锈钢

Specifications subject to change without prior notice. Please refer to the physical product for the most up-to-date information.

技术参数如有改动，以实物为准，恕不另行通知。

Manufacturer Email: [support@smallrig.com](mailto:support@smallrig.com)

Manufacturer: Shenzhen Leqi Innovation Co., Ltd.

Add: Rooms 101, 701, 901, Building 4, Gonglianfuji Innovation Park, No. 58, Ping'an Road, Dafu Community, Guanlan Street, Longhua District, Shenzhen, Guangdong, China.

制造商：深圳市乐其创新股份有限公司

地址：中国广东省深圳市龙华区观澜街道大富社区平安路58号共联富基创新园4栋101、701、901

Consignor: Shenzhen LC Co., Ltd.

Add: Room 201, Building 4, Gonglianfuji Innovation Park, No. 58, Ping'an Road, Dafu Community, Guanlan Street, Longhua District, Shenzhen, Guangdong, China.

委托商：深圳市乐长科技有限公司

地址：中国广东省深圳市龙华区观澜街道大富社区平安路58号共联富基创新园4栋201

执行标准：GB/T 26572-2011



Séparez les éléments avant de trier



中国制造

Made in China