

SmallRig

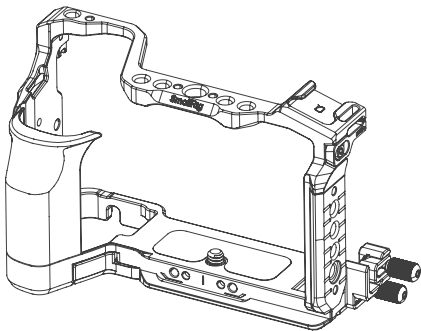

"HawkLock" Quick Release Cage

for Sony Alpha 7C II / 7CR

「迅鹰」快拆拓展框 (适用于索尼 Alpha 7C II / 7CR)

Operating Instruction / 操作指引

- Thank you for purchasing SmallRig's product.
感谢您购买 SmallRig 产品。
- Please read this Operating Instruction carefully.
使用本产品之前, 请仔细阅读操作指引。
- Please follow the safety warnings.
请注意所有警告提示并遵循使用操作指引的所有指令。

In the Box / 包装清单

Cage 拓展框	× 1	Guarantee Card 保修卡	× 1
HDMI Cable Clamp HDMI 线夹	× 1	Operating Instruction 操作指引	× 1

Product Details / 产品介绍

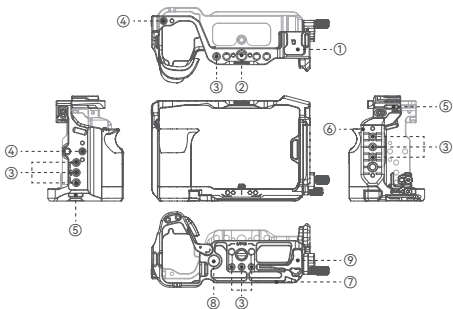

- | | | |
|--|--|--|
| ① Cold Shoe Mount
冷靴 | ④ 1/4"-20 Locating Hole
1/4"-20 定位孔 | ⑦ H38 Arca-Swiss Quick Release Plate
迅鹰H38阿卡规格快装板 |
| ② ARRI 3/8"-16 Locating Hole
阿莱定位孔 | ⑤ Strap Slot
肩带 / 腕带接口 | ⑧ QD Socket
QD接口 |
| ③ 1/4"-20 Threaded Hole
1/4"-20 螺纹孔 | ⑥ H21 NATO Rail
迅鹰H21 滑条 | ⑨ Double Head Wrench
双头扳手 |

Cage Installation / 拓展框安装步骤

Step 1: Use the double head wrench to loosen the M3 screws on both sides of the cage.

第一步：使用双头扳手将拓展框左右两侧的M3螺丝拧松。

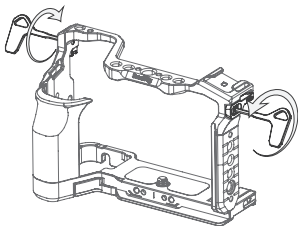

Step 2: Put the camera into the cage from the back, and tilt the locating blocks outwards (about 20 degrees) until the camera is fully inserted.

第二步: 将相机从后往前放入拓展框, 放入过程中把双侧压块向外翘起打开约20°直至相机完全推到底。

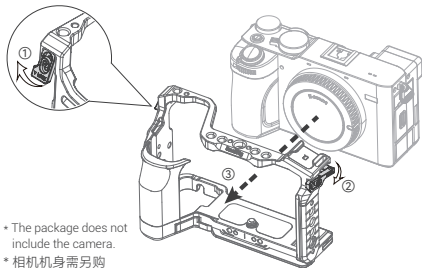

* The package does not include the camera.

* 相机机身需另购

Step 3: Fix the locating blocks to the camera's triangular ring, then use the double head wrench to tighten the M3 screw on both sides of the cage.

第三步: 将左右两侧压块卡在相机三角环上，用双头扳手拧紧拓展框左右两侧的M3螺丝。

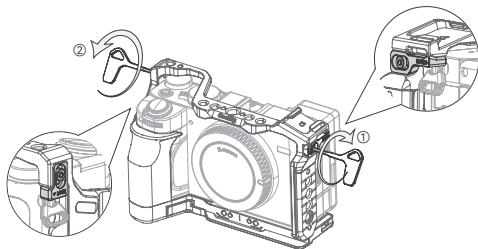

Step 4: Use the double head wrench to secure the cage by tightening the 1/4"-20 screw.

第四步: 通过双头扳手拧紧底部1/4"-20 螺丝，锁紧固定拓展框。

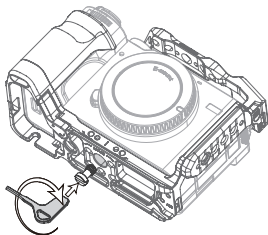

* The package does not include the camera.

* 相机机身需另购

Cable Clamp Installation / 线夹安装步骤

Step 1: Open the camera HDMI interface, align the thumbscrew to the corresponding position, and lock it to the cage.

第一步：打开相机HDMI接口盖，通过手拧螺丝将线夹对准相应位置锁紧至拓展框。

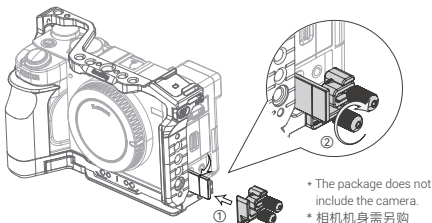

Step 2: Insert the cable and tighten the thumbscrews to secure the cable.

第二步：插入线材，通过手拧螺丝锁紧固定线材。

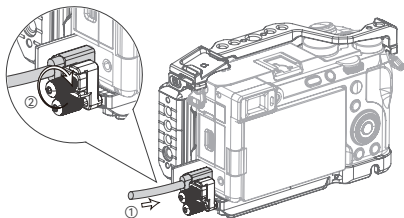

* The package does not include the camera.

* 相机机身需另购

Specifications / 产品参数

Product Dimensions 产品尺寸	5.6 × 2.7 × 3.7in 141.8 × 67.7 × 94.1mm
Product Weight 产品重量	6.9 ± 0.2oz 197.0 ± 5.0g
Material(s) 主要材质	Aluminum Alloy, Silicone 铝合金、硅胶
Compatibility 兼容性	Sony Alpha 7C II / 7CR 索尼 Alpha 7C II / 7CR

Specifications subject to change without prior notice. Please refer to the physical product for the most up-to-date information.

技术参数如有改动，以实物为准，恕不另行通知。

LQ-P1451-18

Manufacturer Email: support@smallrig.com

Manufacturer: Shenzhen Leqi Innovation Co., Ltd.

Add: Rooms 101, 701, 901, Building 4, Gonglianfuji Innovation Park, No. 58, Ping'an Road, Dafu Community, Guanlan Street, Longhua District, Shenzhen, Guangdong, China.

制造商：深圳市乐其创新股份有限公司

地址：中国广东省深圳市龙华区观澜街道大富社区平安路58号共联富基创新园4栋101、701、901

Consignor: Shenzhen LC Co., Ltd.

Add: Room 201, Building 4, Gonglianfuji Innovation Park, No. 58, Ping'an Road, Dafu Community, Guanlan Street, Longhua District, Shenzhen, Guangdong, China.

委托商：深圳市乐其创新股份有限公司

地址：中国广东省深圳市龙华区观澜街道大富社区平安路58号共联富基创新园4栋201

执行标准：GB/T 26572-2011

RoHS **CE**



Séparez les éléments avant de trier



中国制造

Made in China