

SmallRig

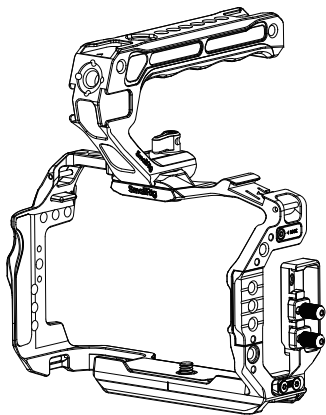

Cage Kit (for Canon EOS R6 Mark II)

拓展框套件 (适用于佳能 EOS R6 Mark II)

Operating Instruction / 操作指引

- Thank you for purchasing SmallRig's product.
感谢您购买 SmallRig 产品。
- Please read this Operating Instruction carefully.
使用本产品之前，请仔细阅读操作指引。
- Please follow the safety warnings.
请注意所有警告提示并遵循使用操作指引的所有指令。

In the Box / 包装清单

Cage 拓展框	× 1	Top Handle 上提手柄	× 1	M3 Screw M3 螺丝	× 2
Allen Wrench 内六角扳手	× 1			Operating Instruction 操作指引	× 1
HDMI & USB-C Cable Clamp HDMI & USB-C线夹	× 1			Guarantee Card 保修卡	× 1

Specifications / 产品参数

Product Dimensions 产品尺寸	6.9 × 5.3 × 7.2in 177.4 × 135.0 × 183.1mm
Product Weight 产品重量	12.0 ± 0.2oz 340.4 ± 5.0g
Material(s) 主要材质	Aluminium Alloy, Silicone, Stainless Steel 铝合金，硅胶，不锈钢

Product Details / 产品介绍

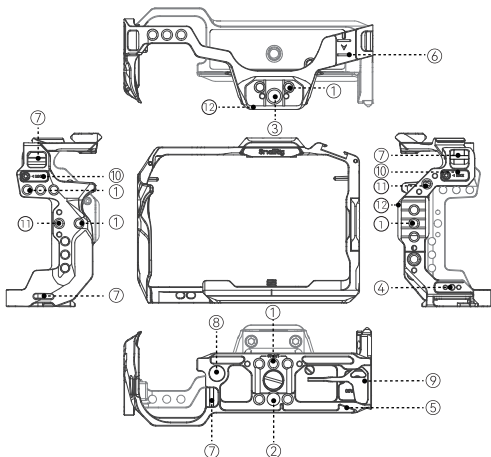

- | | | |
|--|---|--|
| ① 1/4"-20 Threaded Hole
1/4"-20 螺纹孔 | ⑤ H38 Arca-Swiss Quick Release Plate
H38 快拆阿卡规格快装板 | ⑨ Dual-Head Wrench
双头扳手 |
| ② 3/8"-16 Threaded Hole
3/8"-16 螺纹孔 | ⑥ H18 Cold Shoe
H18冷靴 | ⑩ Side Lock Adapter
定位压块 |
| ③ ARRI 3/8"-16 Locating Hole
阿莱定位孔 | ⑦ Strap Slot
肩带孔 | ⑪ 1/4"-20 Locating Hole
1/4"-20 定位孔 |
| ④ M4 Threaded Hole
M4螺纹孔 | ⑧ QD Socket
QD接口 | ⑫ H21 NATO Rail
H21滑条 |

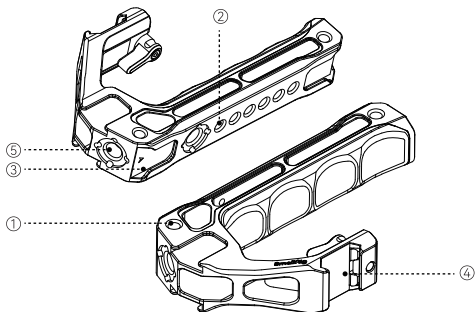

① 1/4"-20 Threaded Hole
1/4"-20 螺纹孔

② 1/4"-20 Locating Hole
1/4"-20 定位孔

③ Cold Shoe
冷靴

④ NATO Clamp
滑槽

⑤ ARRI 3/8"-16 Locating Hole
阿莱定位孔

Cage Installation

拓展框安装步骤

- (1) Before installing, remove the locating blocks on the sides of the cage by using the dual-head wrench.

在安装之前，请先用双头扳手卸下拓展框两侧的定位压块。

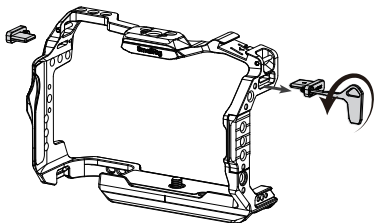

- (2) Put the camera into the cage from back to the front, and then secure the cage by tightening the 1/4"-20 screw at the base with dual-head wrench.

将相机从后往前放入相机拓展框,然后用双头扳手拧紧底部1/4"-20螺丝,锁紧固定拓展框。

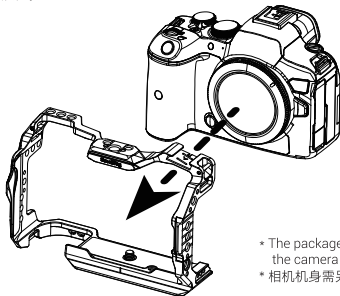

* The package does not include the camera.

* 相机机身需另购

(3) Secure the cage and camera strap slots by tightening two locating blocks on the sides of the cage.

通过双侧定位压块,锁紧固定拓展框和相机肩带槽。

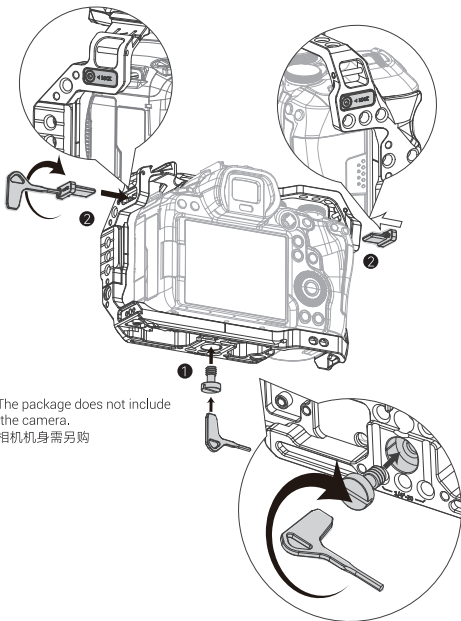

Top Handle Installation / 上手提安装步骤

(1) Slide the top handle with NATO clamp into the NATO rail and lock it.

将带滑槽的上手提滑入滑条并锁紧。

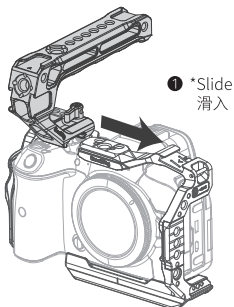

* The package does not include the camera.

* 相机机身需另购

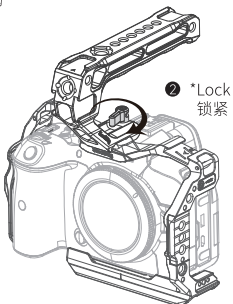

* The package does not include the camera

* 相机机身需另购

HDMI & USB-C Cable Clamp Installation

HDMI & USB-C线夹安装步骤

- (1) ❶: Install the cable clamp onto the cage by tightening the thumbscrew.
: 通过一颗手拧螺丝，将线夹和拓展框锁紧固定。

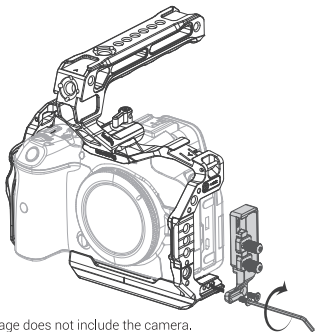

* The package does not include the camera.

* 相机机身需另购

- ❷ Insert the HDMI & USB-C cable.
插入HDMI & USB-C线。

- ❸ Tighten the thumbscrew to secure the cable.
拧紧手拧螺丝固定线材。

* The package does not include the camera

* 相机机身需另购

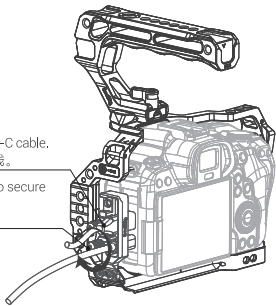

Manufacturer Email: support@smallrig.com

Manufacturer: Shenzhen Leqi Innovation Co., Ltd.

制造商: 深圳市乐其创新股份有限公司

Add: Rooms 101, 701, 901, Building 4, Gonglianfuji Innovation Park, No. 58,
Ping'an Road, Dafu Community, Guanlan Street, Longhua District,
Shenzhen, Guangdong, China.

地址: 中国广东省深圳市龙华区观澜街道大富社区平安路58号共联富基创新园4栋
101、701、901

Consignor: Shenzhen LC Co., Ltd.

委托商: 深圳市乐长科技有限公司

Add: Room 201, Building 4, Gonglianfuji Innovation Park, No. 58, Ping'an Road,
Dafu Community, Guanlan Street, Longhua District, Shenzhen,
Guangdong, China.

地址: 中国广东省深圳市龙华区观澜街道大富社区平安路58号共联富基创新园4栋201

执行标准: GB/T 26572-2011

LQ-P1435-18

RoHS



Séparez les éléments avant de trier

中国制造
Made in China



SmallRig

--FREE YOUR DREAM--