

SmallRig

- EN** User manual
- DE** Bedienungsanleitung
- FR** Manuel d'utilisation
- IT** Manuale dell'utente
- ES** Manual del usuario
- PT** Manual do usuário
- NL** Gebruiksaanwijzing
- SE** Gebruikershandleiding
- KR** 사용자 설명서

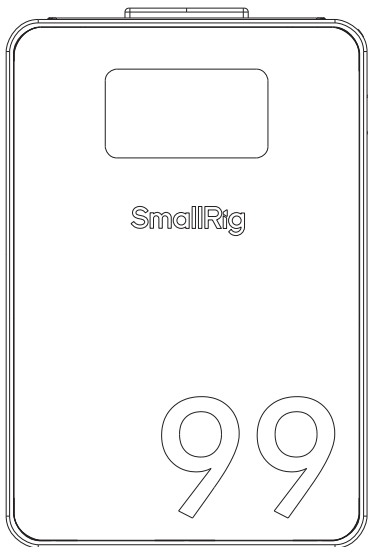

VB99 Pro **mini V Mount Battery**

Product Details | Produkte | Introduction du produit | Descrizione del prodotto | Presentación del producto
Apresentação do Produto | Productinleiding | Produktbeskrivning | 제품 소개

1

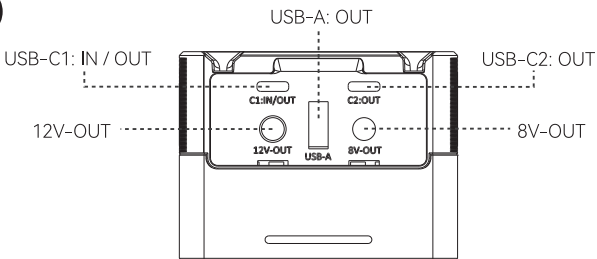

3

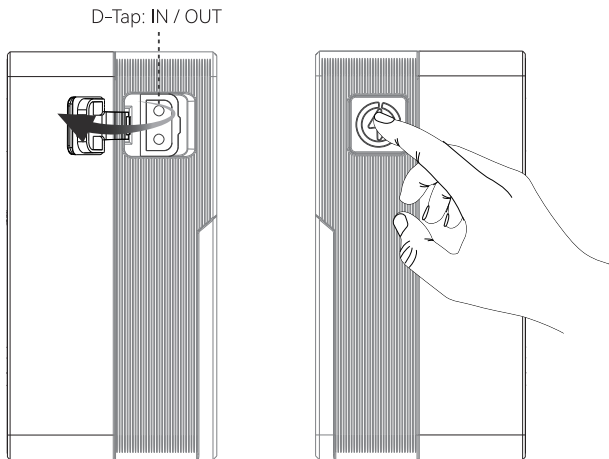

2

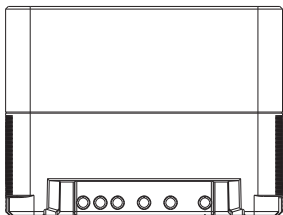

BP: IN / OUT

4

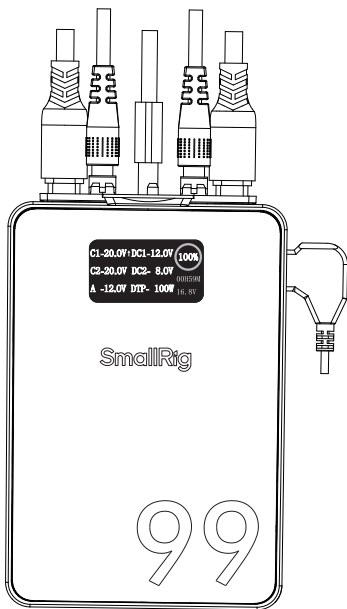

PD

EN: Pause discharging

DE: Begrenzung der Entladung

FR: Pause de décharge

IT: Limitare lo scarico

ES: Pausa de descarga

PT: Pausar descarga

NL: Pauzeren bij het ontladen

SE: Pausa urladdning

KR: 방전 제한

PC

EN: Pause USB-C1 charging

DE: Begrenzung der USB-C1-Entladung

FR: Pause de la charge de l'USB-C1

IT: Limita la ricarica USB-C1

ES: Pausa de carga del USB-C1

PT: Pausar carregamento USB-C1

NL: Pauzeren bij het opladen via USB-C1

SE: Pausa USB-C1-laddning

KR: USB-C1 충전 제한

OC

EN: Overcurrent

DE: Abnormaler Überstrom

FR: Surintensité

IT: Anomalia da sovracorrente

ES: Sobrecorriente

PT: Sobrecorrente

NL: Overstroom

SE: Överström

KR: 과전류

OV

EN: Overvoltage

DE: Abnormale Überspannung

FR: Surtension

IT: Anomalia da sovratensione

ES: Sobretensión

PT: Sobretensão

NL: Overspanning

SE: Överspänning

KR: 과전압

HT

EN: Battery temperature $\geq 45^{\circ}\text{C}$
DE: Batterietemperatur $\geq 45^{\circ}\text{C}$
FR: Température de la batterie $\geq 45^{\circ}\text{C}$
IT: Temperatura della batteria $\geq 45^{\circ}\text{C}$
ES: Temperatura de la batería $\geq 45^{\circ}\text{C}$

PT: Temperatura da bateria $\geq 45^{\circ}\text{C}$
NL: Batterijtemperatuur $\geq 45^{\circ}\text{C}$
SE: Batteritemperatur $\geq 45^{\circ}\text{C}$
KR: 배터리 온도 $\geq 45^{\circ}\text{C}$

LT

EN: Battery temperature $\leq 0^{\circ}\text{C}$
DE: Batterietemperatur $\leq 0^{\circ}\text{C}$
FR: Température de la batterie $\leq 0^{\circ}\text{C}$
IT: Temperatura della batteria $\leq 0^{\circ}\text{C}$
ES: Temperatura de la batería $\leq 0^{\circ}\text{C}$

PT: Temperatura da bateria $\leq 0^{\circ}\text{C}$
NL: Batterijtemperatuur $\leq 0^{\circ}\text{C}$
SE: Batteritemperatur $\leq 0^{\circ}\text{C}$
KR: 배터리 온도 $\leq 0^{\circ}\text{C}$

TDP-

EN: Total discharging power (Displayed in red font when $\text{TDP} \geq 100\text{W}$)
DE: Gesamtentladungsleistung (Wenn $\text{TDP} \geq 100\text{W}$ wird sie in roter Schrift angezeigt)
FR: Puissance de décharge totale (Lorsque $\text{TDP} \geq 100\text{W}$, il est affiché en rouge)
IT: Potenza di scarica totale (Visualizzazione in carattere rosso quando $\text{TDP} \geq 100\text{W}$)
ES: Potencia total de descarga (Cuando $\text{TDP} \geq 100\text{W}$, se muestra en rojo)
PT: Potência total de descarga (Quando o $\text{TDP} \geq 100\text{W}$, é apresentado a vermelho)
NL: Totaal ontladvermogen (Wanneer de $\text{TDP} \geq 100\text{W}$, wordt deze in het rood weergegeven)
SE: Total urladdningseffekt (När $\text{TDP} \geq 100\text{W}$ visas det i rött)
KR: 총 방전 전력 ($\text{TDP} \geq 100\text{W}$ 는 빨간색 글씨체로 표시됩니다)

EN Specifications

Item	Specification
Material	Aluminum Alloy + Fireproof PC Material
Battery Parameter	14.54 V 6.8 Ah 98,872 Wh
Rated Total Discharging Power	100 W
BP / D-Tap Input	8 A (Max)
BP / D-Tap Output	14,8 V = 14 A (Max)
USB-A Output Supporting QC2.0/QC3.0	5 V = 3 A, 9 V = 3 A, 12 V = 2,5 A (Max)
USB-C1 Input / Output Input / Output 100W (Max) Supporting PD3.0 / QC2.0 / QC3.0 / PPS	5 V = 3 A, 9 V = 3 A, 12 V = 3 A, 15 V = 3 A, 20 V = 5 A (Max)
USB-C2 Output Output 100W (Max) Supporting PD3.0 / QC2.0 / QC3.0 / PPS	5 V = 3 A, 9 V = 3 A, 12 V = 3 A, 15 V = 3 A, 20 V = 5 A (Max)
8V-OUT Output	8 V = 3 A (Max)
12V-OUT Output	12 V = 3 A (Max)
Discharging Cut-off Voltage	11 V
Optional Charging Methods	BP interface charger, 16,8 V D-Tap charger, USB-C charger
Product Weight	644,0 ± 10,0g
Product Dimensions	107,2 × 73,2 × 55,2mm

DE Produktparameter

Artikel	Spezifikation
Material	Aluminiumlegierung + feuerfestes PC-Material
Kapazität	14,54 V 6,8 Ah 98,872 Wh
Nennleistung der Gesamtentladung	100 W
BP / D-Tap-Eingang	8 A (Max)
BP / D-Tap-Ausgang	14,8 V = 14 A (Max)
USB-A-Ausgang QC2.0 / QC3.0 wird unterstützt	5 V = 3 A, 9 V = 3 A, 12 V = 2,5 A (Max)
USB-C1 - Eingang / Ausgang Eingang / Ausgang 100 W (Max) PD3.0 / QC2.0/QC3.0 / PPS wird unterstützt	5 V = 3 A, 9 V = 3 A, 12 V = 3 A, 15 V = 3 A, 20 V = 5 A(Max)
USB-C2-Ausgang Ausgang 100 W (Max) PD3.0 / QC2.0 / QC3.0 / PPS wird unterstützt	5 V = 3 A, 9 V = 3 A, 12 V = 3 A, 15 V = 3 A, 20 V = 5 A(Max)
8 V -OUT-Ausgang	8 V = 3 A (Max)
12 V-OUT-Ausgang	12 V = 3 A (Max)
Abschaltspannung der Entladung	11 V
Optionale Lademethoden	BP Interface Ladegerät, 16,8V D-Tap Ladegerät, USB-C Ladegerät
Produktgewicht	644,0 ± 10,0g
Produktgröße	107,2 × 73,2 × 55,2 mm

FR Paramètres du produit

Élément	Spécifications
Matériau	Alliage d'aluminium + matériau PC ignifugé
Capacité	14,54 V 6,8 Ah 98,872 Wh
Puissance de décharge totale nominale	100 W
Entrée BP / D-Tap	8 A (Max)
Sortie BP / D-Tap	14,8 V \approx 14 A (Max)
Sortie USB-A Prise en charge de QC2.0 / QC3.0	5 V \approx 3 A, 9 V \approx 3 A, 12 V \approx 2,5 A (Max)
Entrée / sortie USB-C1 Entrée / sortie 100 W (Max) Prise en charge de PD3.0 / QC2.0 / QC3.0 / PPS	5 V \approx 3 A, 9 V \approx 3A, 12 V \approx 3 A, 15 V \approx 3 A, 20 V \approx 5 A(Max)
Sortie USB-C2 Sortie 100 W (Max) Prise en charge de PD3.0 / QC2.0 / QC3.0 / PPS	5 V \approx 3 A, 9 V \approx 3A, 12 V \approx 3 A, 15 V \approx 3 A, 20 V \approx 5 A(Max)
Sortie 8 V-OUT	8 V \approx 3 A (Max)
Sortie 12V-OUT	12 V \approx 3 A (Max)
Tension de coupure de la décharge	11 V
Méthode de chargement optionnelle	Chargeur avec port BP, chargeur D-Tap 16,8 V, chargeur USB-C
Poids du produit	644,0 \pm 10,0g
Taille du produit	107,2 \times 73,2 \times 55,2mm

IT Parametri del prodotto

Progetto	Specifica
Materiale	Leghe di alluminio + materiale PC ignifugo
Capacità	14,54 V 6,8 Ah 98,872 Wh
Potenza di scarica totale nominale	100 W
Ingresso BP / D-Tap	8 A (Massimo)
Uscita BP / D-Tap	14,8 V \approx 14 A (Massimo)
Uscita USB-A Supporta QC2.0 / QC3.0	5 V \approx 3 A, 9 V \approx 3 A, 12 V \approx 2,5 A (Massimo)
Ingresso / uscita USB-C1 Ingresso / uscita 100W (Massimo) Supporta PD3.0 / QC2.0 / QC3.0 / PPS	5 V \approx 3 A, 9 V \approx 3A, 12 V \approx 3 A, 15 V \approx 3 A, 20 V \approx 5 A (Massimo)
Uscita USB-C2 Uscita 100W (Massimo) Supporta PD3.0 / QC2.0 / QC3.0 / PPS	5 V \approx 3 A, 9 V \approx 3A, 12 V \approx 3 A, 15 V \approx 3 A, 20 V \approx 5 A (Massimo)
Uscita 8V-OUT	8 V \approx 3 A (Massimo)
Uscita 12V-OUT	12 V \approx 3 A (Massimo)
Tensione di interruzione di scarica	11 V
Metodi di ricarica opzionali	Caricabatterie con interfaccia BP, caricabatterie D-Tap da 16,8V, caricabatterie USB-C
Peso di prodotto	644,0 \pm 10,0g
Taglia del prodotto	107,2 \times 73,2 \times 55,2mm

ES **Parámetros del producto**

Artículo	Especificación
Material	Aleación de aluminio + material de PC ignífugo
Capacidad	14,54 V 6,8 Ah 98,872 Wh
Potencia nominal de descarga total	100 W
Entrada BP / D-Tap	8 A (Máx.)
Salida BP / D-Tap	14,8 V = 14A (Máx.)
Salida USB-A Soporta QC2.0 / QC3.0	5 V = 3 A, 9 V = 3 A, 12 V = 2,5 A (Máx.)
Entrada / Salida USB-C1 Entrada / Salida 100W (Máx.) Soporta PD3.0 / QC2.0 / QC3.0 / PPS	5 V = 3 A, 9 V = 3 A, 12 V = 3 A, 15 V = 3 A, 20 V = 5 A (Máx.)
Salida USB-C2 Salida 100W (Máx.) Soporta PD3.0 / QC2.0 / QC3.0 / PPS	5 V = 3 A, 9 V = 3 A, 12 V = 3 A, 15 V = 3 A, 20 V = 5 A (Máx.)
Salida 8V-OUT	8 V = 3 A (Máx.)
Salida 12V-OUT	12 V = 3 A (Máx.)
Voltaje de corte de descarga	11 V
Métodos de carga opcionales	Cargador de interfaz BP, Cargador D-Tap de 16,8 V, Cargador USB-C
Peso del Producto	644,0 ± 10,0g
Tamaño del producto	107,2 × 73,2 × 55,2mm

PT **Especificações do Produto**

Item	Especificação
Material	Liga de alumínio + material de PC retardante de chamas
Capacidade	14,54 V 6,8 Ah 98,872 Wh
Potência total de descarga nominal	100 W
Entrada BP / D-Tap	8 A (Máx.)
Saída BP / D-Tap	14,8 V = 14 A (Máx.)
Saída USB-A Suporte QC2.0 / QC3.0	5 V = 3 A, 9 V = 3 A, 12 V = 2,5 A (Máx.)
Entrada / Saída USB-C1 Entrada / Saída 100W (Máx.) Suporte PD3.0 / QC2.0 / QC3.0 / PPS	5 V = 3 A, 9 V = 3 A, 12 V = 3 A, 15 V = 3 A, 20 V = 5 A (Máx.)
Saída USB-C2 Saída 100W (Máx.) Suporte PD3.0 / QC2.0 / QC3.0 / PPS	5 V = 3 A, 9 V = 3 A, 12 V = 3 A, 15 V = 3 A, 20 V = 5 A (Máx.)
Saída 8V-OUT	Saída 8 V = 3 A (Máx.)
Saída 12V-OUT	Saída 12 V = 3 A (Máx.)
Voltagem de corte de descarga	11 V
Métodos opcionais de carregamento	Carregador via porta BP, carregador via D-Tap 16,8V, carregador via USB-C
Peso do produto	644,0 ± 10,0g
Dimensões do produto	107,2 × 73,2 × 55,2mm

NL Productparameters

Item	Specificatie
Materiaal	Aluminiumlegering + Vuurvast PV-materiaal
Capaciteit	14,54 V 6,8 Ah 98,872 Wh
Totaal Nominiaal Ontlaadvermogen	100 W
BP / D-Tap-ingang	8 A (Max.)
BP/ D-Tap -uitgang	14,8 V = 14 A (Max.)
USB-A-uitgang Ondersteuning voor QC2.0 / QC3.0	5 V = 3 A, 9 V = 3 A, 12 V = 2,5 A (Max.)
USB-C1-in- / uitgang In- / uitgang 100 W (Max.) Ondersteuning voor PD3.0 / QC2.0 / QC3.0 / PPS	5 V = 3 A, 9 V = 3 A, 12 V = 3 A, 15 V = 3 A, 20 V = 5 A (Max.)
USB-C2-uitgang Uitgang 100W (Max.) Ondersteuning voor PD3.0 / QC2.0 / QC3.0 / PPS	5 V = 3 A, 9 V = 3 A, 12 V = 3 A, 15 V = 3 A, 20 V = 5 A (Max.)
8V-UIT Uitgang	8 V = 3 A (Max.)
12V-UIT Uitgang	12 V = 3 A (Max.)
Cut-off ontlaadspanning	11 V
Optionele Oplaadmethode	BP-interfacelader, 16,8V D-Tap-oplader, USB-C-oplader
Productgewicht	644,0 ± 10,0g
Productafmetingen	107,2 × 73,2 × 55,2mm

SE Produktparametrar

Artikel	Specifikation
Material	Aluminiumlegering + brandsäkert PC-material
Kapacitet	14,54 V 6,8 Ah 98,872 Wh
Nominell total urladdningseffekt	100 W
BP / D-Tap Ingång	8 A (Max)
BP / D-Tap Utgång	14,8 V = 14 A (Max)
USB-A Utgång Stöd för QC2.0 / QC3.0	5 V = 3 A, 9 V = 3 A, 12 V = 2,5 A (Max)
USB-C1 Ingång / Utgång Ingång / Utgång 100W (Max) Stöd för PD3.0 / QC2.0 / QC3.0 / PPS	5 V = 3 A, 9 V = 3 A, 12 V = 3 A, 15 V = 3 A, 20 V = 5 A (Max)
USB-C2-utgång Utgång 100W (max) Stöd för PD3.0 / QC2.0 / QC3.0 / PPS	5 V = 3 A, 9 V = 3 A, 12 V = 3 A, 15 V = 3 A, 20 V = 5 A (Max)
8V-OUT Utgång	8 V = 3 A (Max)
12V-OUT Utgång	12 V = 3 A (Max)
Avstängningsspänning för urladdning	11 V
Valfria laddningsmetoder	BP-laddare, 16,8 V D-Tap-laddare, USB-C-laddare
Produktens vikt	644,0 ± 10,0g
Produktens mått	107,2 × 73,2 × 55,2mm

KR 제품 파라미터

프로젝트	규격
재질	알루미늄 합금 + 방화 PC 재질
용량	14.54V 6.8Ah 98.872Wh
정격 방전 충전력	100W
BP / D-Tap 입력	8A (Max)
BP / D-Tap 출력	14.8V ~ 14A (Max)
USB-A 출력 QC2.0 / QC3.0 지원	5V ~ 3A, 9V ~ 3A, 12V ~ 2.5A (Max)
USB-C1 입력 / 출력 100W (Max) 입력 / 출력 PD3.0 / QC2.0 / QC3.0 / PPS 지원	5V ~ 3A, 9V ~ 3A, 12V ~ 3A, 15V ~ 3A, 20V ~ 5A (Max)
USB-C2 출력 100W (Max) 출력 PD3.0 / QC2.0 / QC3.0 / PPS 지원	5V ~ 3A, 9V ~ 3A, 12V ~ 3A, 15V ~ 3A, 20V ~ 5A (Max)
8V-OUT 출력	8V ~ 3A (Max)
12V-OUT 출력	12V ~ 3A (Max)
방전 차단 전압	11V
선택 가능한 충전 방식	BP 충전기, 16.8VD-Tap 충전기, USB-C 충전기
제품 무게	644.0 ± 10.0g
제품 사이즈	107.2 × 73.2 × 55.2mm

The product has been covered by the liability insurance of PICC Property and Casualty Co., Ltd.

LQ-P1112-18B

执行标准: GB 31241-2022

CE RoHS FC



인증번호: XU103204-23002A
A / S: 0232730818
제조년월: 2023.12

IS 16046(Part2) / IEC 62133-2:2017



Points de collecte sur www.quefairedemesdechets.fr
Privilégiez la réparation ou le don de votre appareil !

R-41250511
www.bis.gov.in