

SmallRig

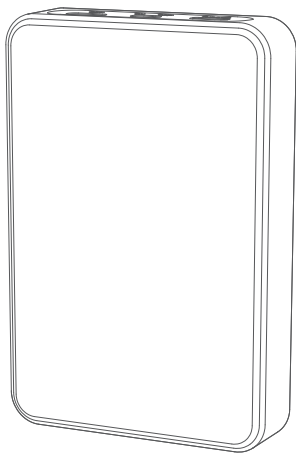

RM75 RGBWW Video Light

User Manual

Foreword

Thank you for purchasing the SmallRig RM75 RGBWW Video Light

Instructions

- Please read this User Manual carefully.
- Keep this User Manual and always include it when passing the product onto third party.
- Heed all warnings and follow all instructions in this User Manual.
- Never remove the non-detachable lithium battery without permission.
- When the battery is not in use for a long time, please charge and discharge the battery every 6months, and provide it with about 60% of the electric quantity to prolong its use life.
- Since there are some hazardous substances in the battery, please do not discard it. Instead, dispose of the product that is damaged or will never be used according it the waste management measures.



WARNING: Do not disassemble the product or change its battery. If you have any questions, please contact the seller to apply after-sales service.

Intended Use

Intended use of the SmallRig RM75 includes:

- The user has read the instructions of this manual.
- The user is using the products within the operating conditions and limitations described in this user manual.
- "Improper use" means using the products other than as described in these instructions or under operating conditions which differ from those described herein.

In the Box

Package includes the following items:



RM75 ×1

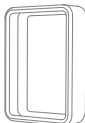

Silicone Rubber
Diffuser ×1



USB-C
Charging Cable ×1



Chinese and English
User Manual ×1

Product Details

1. OLED Screen
2. SET
3. Power Switch
4. USB-C Charging Port
5. LED Beads
6. 1/4"-20 Screw Mount

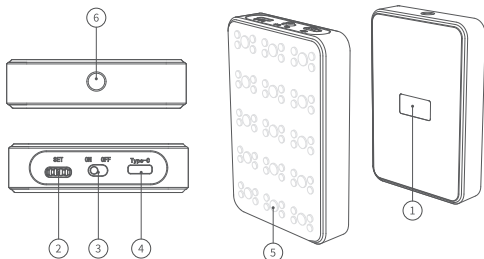

Operation Instructions

1.Charging

USB-C charging

As the light is charging, the on-screen battery level indicator will animate to show the battery's status. After the battery is fully charged, the battery level indicator will be displayed as full.

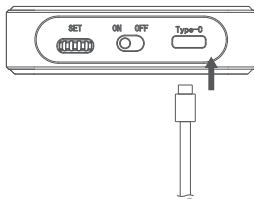

- Supports DC5V,2A/9V,2A charging via power brick or power bank.
- Supports quick charging via USB-C PD protocol.
- Charging is slow when the light is powered on. Turn the light off for optimal charging.
- The on-screen battery indicator will flash when the battery level is too low. Please charge the light in time.
- The brightness may be affected when the temperature of the lamp is too high.

2. Power ON / OFF

Adjust the position of the power switch to turn the light on or off.

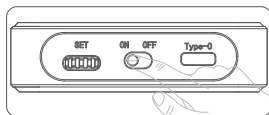

3.CCT Mode

Press and hold the control wheel for 2 seconds to access the system menu. Rotate the control wheel to select CCT and press the wheel to enter CCT mode. "Short press" the wheel to select intensity(INT) control, and turn the wheel to adjust the brightness level from 0 ~ 100%. In CCT Mode, rotate the control wheel to adjust the color temperature between 2500K ~ 8500K.

VER	7.2h	
CCT	INT 15%	
	CCT 7500 K	
HSI	G/M 0	

VER	7.1h	
CCT	INT 24%	
	CCT 7400K	
HSI	G/M 0	

- Access more fine control via the SmallGoGo mobile application.

4.HSI Mode

Press and hold the control wheel for 2 seconds to access the system menu. Rotate the control wheel to select HSI and press the wheel to enter HSI mode. In HSI Mode, "short press" the control wheel to toggle between HUE / SAT (saturation) / INT(intensity) controls. When controlling HUE rotate the control wheel to adjust the hue color from 0 ~ 360 ° . When controlling saturation (SAT), turn the control wheel to adjust the color saturation between 0 ~ 100%. When controlling intensity (INT), turn the wheel to adjust the brightness level between 0 ~ 100%.



HSI



HUE



SAT



INT

5. FX Mode

Press and hold the control wheel for 2 seconds to access the system menu. Rotate the control wheel to select FX and press the wheel to enter FX mode.

In FX mode, rotate the control wheel to toggle between different lighting FX presets: RGB, Paparazzi,

Party, Lightning, Fault bulb, TV, Fire, Random, Fireworks, Police car, Fire truck, Ambulance, Welding, SOS, Pulsing. Once you have selected your desired lighting effect, "short press" the control wheel to access intensity(INT) control. Rotate the control wheel to adjust the brightness of the lighting effect from 0 ~ 100%.



RGB



Paparazzi



Party



Lightning



Fault bulb



TV



Fire



Random



Fireworks



Police car



Fire truck



Ambulance



Welding



SOS



Pulsing

6. Bluetooth Mode

Press and hold the control wheel for 2 seconds to access the system menu. Rotate the control wheel to select BT and press the wheel to the Bluetooth Reset menu. Rotate the control wheel to select "YES" and short press the wheel to reset the device's Bluetooth pairing, (the pop-up window displays the current reset progress. The reset process completes within 5 seconds.) or select "NO" to return to the system menu.



7. Attaching the Silicone Diffuser

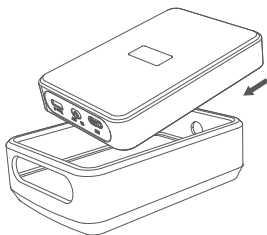

8. Using the Magnets

- Don't attach this device or the magnets to any surface with a temperature above 80 °C.

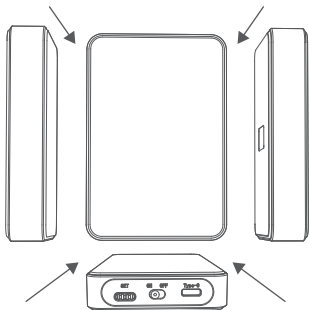

- Please pay attention to the placement of your fingers to prevent pinching when the lights are spliced.

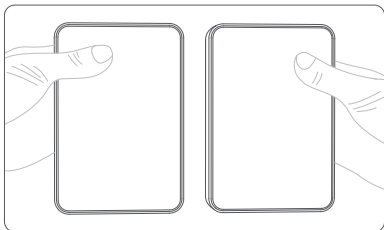

- Don't store the lights with bank cards, watches, or other precious objects in case of damage.

9.Using the SmallGoGo APP

You can download the SmallGoGo app from the iOS App Store or Google Play Store for enhancing the functionality of the light. Please visit www.smallgo-go.com help for more details regarding how to use the app to control your SmallRig lights.



Operation Manual



APP Download

Specification

Power	5W
Color Temperature	2500 k to 8500 k
Illuminance	1300lux@0.3m; 500lux@0.5m; 120lux@1m
CRI	96
TLCI	96
DUV	±0.002
Battery Specification	3.7V 4000mAh 14.8Wh
Battery Operating Life	3hrs @100% brightness; 16hrs @1% brightness
Weight	185g(0.4lb)
Dimension	99×67×18.3mm(39×26×7in)

SmallRig

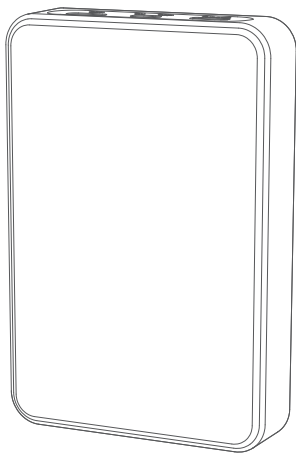

RM75 智能补光灯

用户手册

前言

感谢您购买 SmallRig RM75 智能补光灯。

重要提示

- 请认真阅读本用户手册。
- 请妥善保管用户手册。将产品交给他人使用时，请务必附带本用户手册。
- 请注意所有警告提示并遵循用户手册内的所有指令。
- 本产品含内置式不可拆卸锂电池，严禁擅自拆机。
- 电池在长时间储存不用时，应在 6 个月内进行一次充放电维护，并恢复 60% 左右的带电量，以延长电池的使用寿命。
- 电池内部有少许有害物质，请勿任意丢弃，请将损坏或是不再使用的产品，依照废弃物管理办法回收处理。



警告： 请勿拆卸产品或更换电池，如您怀疑产品有任何问题，请联系购买平台，申请售后处理。

设备使用规范

SmallRig RM75 规范使用包括：

- 仔细阅读本用户手册，特别是“重要提示”部分。
- 在本用户手册规定的工作条件下使用和保存本产品。
- 如不按照本用户手册使用产品，或不遵守规定的工作或保存条件，将被视为违规使用。

包装清单

包装内包含以下物品：



RM75 ×1

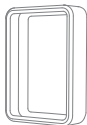

硅胶柔光罩 ×1



USB-C 充电线 ×1



用户手册 ×1

产品视图

1. 显示屏幕
2. SET
3. 开关键
4. USB-C充电接口
5. 灯珠
6. 1/4"-20 螺纹孔

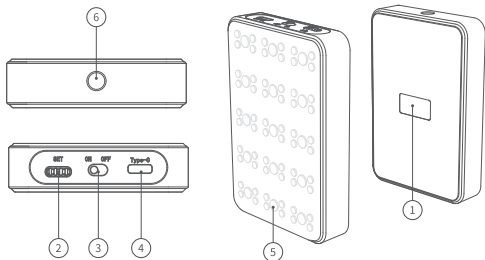

安装与使用

1. 充电

USB-C充电过程中, 屏幕上电量指示图标跑马显示, 充满后, 电量显示满格。

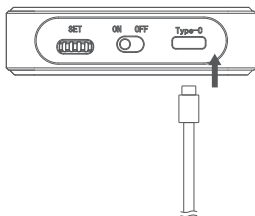

- 支持DC5V, 2A/9V, 2A电源适配器或移动电源充电。
- 支持USB-PD协议的快充进行充电。
- 开机状态充电缓慢, 建议关机后再充电。
- 低电时, 电量指示图标闪烁提示, 请及时充电。
- 灯体温度过高时, 会影响亮度。

2.开 / 关机

拨动开关进行开关机。

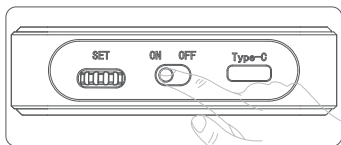

3.色温调节

长按SET 2S进入主菜单, 拨动SET, 选择CCT模式, 短按SET确定, 进入CCT模式。短按SET, 选择INT, 拨动SET, 可对亮度进行调节, 亮度调节范围0 ~ 100%; 拨动SET, 可对色温进行调节, 色温可调节范围2500K ~ 8500K。



色温调节 (CCT)



亮度调节 (INT)

- 通过SmallGoGo移动应用程序可以实现更丰富的灯光细节控制。

4.HSI模式

长按SET 2S进入主菜单, 拨动SET, 选择HSI模式, 短按SET确定, 进入HSI模式后, 短按SET, 可选择HUE / SAT / INT模式, 分别对色调/饱和度/亮度进行调节。HUE模式下, 拨动SET对色调进行调节, 可调节范围0 ~ 360°; 短按SET, 进入SAT模式, 拨动SET对饱和度进行调节, 可调节范围0 ~ 100%; 短按SET, 进入INT模式, 拨动SET对亮度进行调节, 可调节范围0 ~ 100%。



HSI



HUE



SAT



INT

5. 光效模式

长按 SET 2S 进入主菜单，拨动 SET，选择 FX 模式，短按 SET 确定，进入光效模式后，拨动 SET，可进行 RGB/ 狗仔队 / 聚会 / 闪电 / 坏灯泡 / 电视 / 火焰 / 随机模式 / 烟花 / 警车 / 消防车 / 救护车 / 电焊 / SOS / 呼吸 15 种光效切换。短按 SET 可对相应模式的亮度和频率进行调节。



RGB



狗仔队



聚会



闪电



坏灯泡



电视



火焰



随机模式



烟花



警车



消防车



救护车



电焊



SOS



呼吸

6. 蓝牙模式

长按 SET 2S 进入蓝牙主菜单，拨动 SET，选择 BT 模式，短按 SET 确定，进入 BT 重置界面，拨动 SET，选择 YES，短按 SET 确定，会弹出“OK”加载界面，对蓝牙进行重置，加载完成后，自动跳转至主界面；选择 NO，短按 SET 确定，取消重置，自动返回蓝牙主菜单。

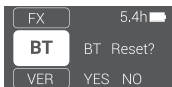

7. 硅胶柔光罩的使用

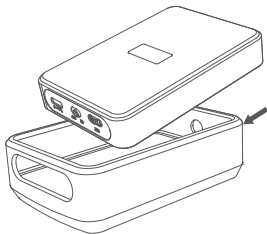

8.磁铁的使用

- 请勿将磁铁吸附在温度超过80°C的表面，以免磁力衰退。

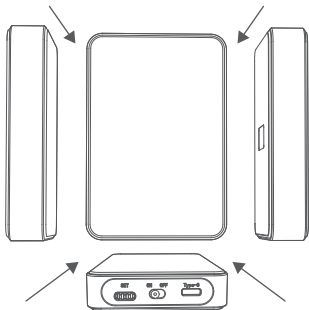

- 两灯拼接时，请注意手指放置位置，以防夹伤。

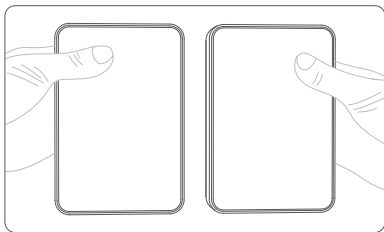

- 请勿将本产品与银行卡、手表等贵重物品一起存放，以免对物品造成损坏。

9.SmallGoGo APP的使用

您可以在App store和安卓市场搜索SmallGoGo下载专业控制软件来控制SmallRig灯具,更多详细使用方法请访问:www.smallgogo.com/cn



操作手册



下载页

规格参数

功率	5W
色温	2500K ~ 8500K
照度	1300lux@0.3米;500lux@0.5米;120lux@1米
CRI	96
TLCI	96
DUV	±0.002
电池规格	3.7V 4000mAh 14.8Wh
续航	最亮100%, 3小时; 最暗1%, 16小时
重量	185g
尺寸	99×67×18.3mm