

SmallRig



iPhone 16 Pro / Pro Max

FilMov Photography Kit

FilMov 手机影像套件

Operating Instruction / 操作指引

- Thank you for purchasing SmallRig's product.
感谢您购买 SmallRig 产品。
- Please read this Operating Instruction carefully.
使用本产品之前，请仔细阅读操作指引。
- Please follow the safety warnings.
请注意所有警告提示并遵循使用操作指引的所有指令。

In the Box / 包装清单

iPhone 16 Pro / Pro Max Case	× 1	lens trim ring	× 1
iPhone 16 Pro / Pro Max 手机壳		镜头装饰框	
CapGrip for Phone	× 1	Operating Instruction	× 1
人机手柄		操作指引	
T-mount Lens Backplate	× 1	Guarantee Card	× 1
T卡口镜头背板		保修卡	

Product Installation / 产品安装

1. Phone Assembly / Disassembly | 装取手机

- (1) Assemble the phone from the bottom up into the phone case, and press and buckle the edge to make sure the phone case fits snugly with the phone.
将手机从底部向上装入手机壳，边缘按压扣紧，确保手机壳与手机贴合。

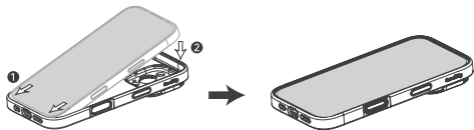

- (2) When removing the phone case, remove it from one corner.
取下手机壳时请从其中一角进行拆卸。



2. Grip Assembly / Disassembly | 装取手柄

- (1) Insert the phone with the case into the handle in the direction as shown. Flip the lock switch at the bottom of the handle downward, and lock the phone case and the handle.

将装好手机壳的手机如图示方向插入手柄。向下拨动手柄底部的锁止开关，手机壳与手柄上锁固定。

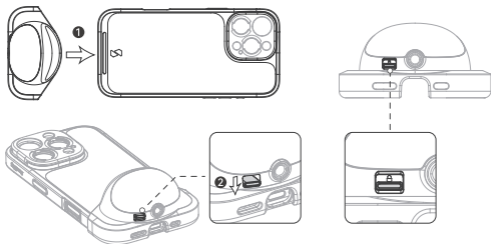

- (2) Remove the handle by toggling the lock switch up to unlock it.

向上拨动锁止开关解锁，将手柄取下。

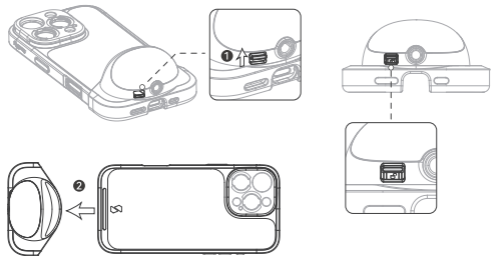

3. Use or Replace the Lens Backplate | 使用或更换镜头背板

- (1) The product comes standard with a lens trim ring and a T-mount lens back plate, which can be used with a T-mount external lens.

产品标配镜头装饰圈和T卡口镜头背板，可使用T卡口外接镜头。

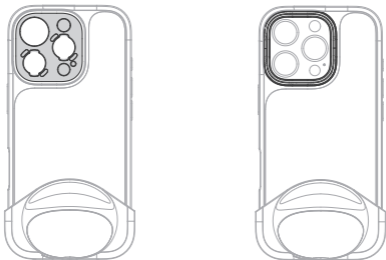

- (2) When sliding into the back panel or bezel, place the side with the circular groove facing up.

滑入背板或装饰框时请将内侧有圆形凹槽的一侧朝上。

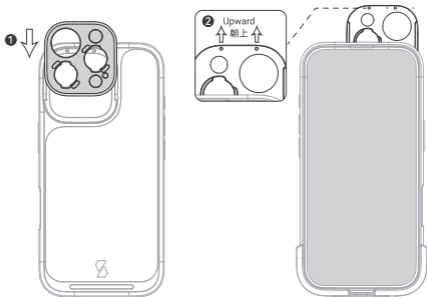

- (3) To replace the lens back plate, simply slide it upwards and substitute it with either a FilMov 17mm threaded lens back plate (ID 4992) or a 67mm magnetic filter adapter (ID 4993). An external lens or filter of the corresponding specification can then be used.

镜头背板向上滑动取出，可替换为FilMov 17mm 螺纹镜头背板（ID 4992）或67mm 磁吸滤镜转接环（ID 4993），并使用相应规格的外接镜头或滤镜。



FilMov 17mm

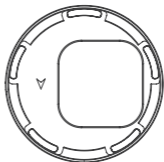

FilMov 67mm



Please note that both of require additional purchase.

请注意两者都需要额外购买！

4. The case with MagSafe function, supports stable and fast wireless charging, and is compatible with **all** kinds of MagSafe accessories.

手机壳磁吸力强，支持稳定快速的无线充电，兼容各类MagSafe配件。

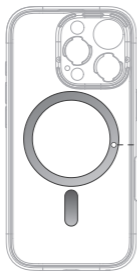

Build-in MagSafe
内置磁吸

6. Connect to Equipment equipped with 1/4-20 threaded holes 连接1/4-20" 螺丝设备

- (1) There are 1/4-20" Threaded Hole in the bottom of the handle, which can be connected to external tripod and other equipment.
手柄下方有1/4-20" 螺丝孔，可外接支架等设备。

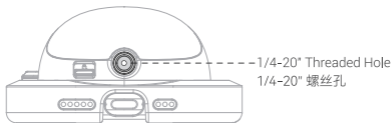

5. Use Lanyard Holes | 使用挂绳孔

- (1) There is a lanyard hole on the left side of the phone case, which can be connected to wristbands, lanyards or decorations.
手机壳左侧设有挂绳孔位，可以接入腕带、挂绳或装饰品使用。

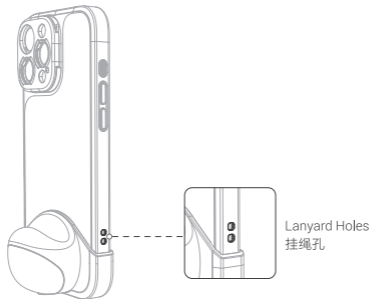

Notes / 注意事项

1. Do not vigorously shake the phone when using the handle or when connecting the external lens.
请勿在使用手柄时或外接镜头时，大力甩撞手机；
2. Do not touch sharp objects with leather to avoid scratching the phone case.
皮革请勿接触锋利物品，避免划伤手机壳；
3. Avoid direct contact with harsh chemicals to avoid damaging the leather.
避免直接接触刺激性化学物质，避免损坏皮革。

Specifications / 产品参数

[iPhone 16 Pro]

Phone Case Dimensions 手机壳尺寸	3.1 × 6.1 × 1.6in 79.7 × 153.6 × 39.4mm
Phone Case Weight 手机壳重量	1.2 ± 0.2oz 35.0 ± 5.0g
Product Weight 产品总重量	2.5 ± 0.2oz 70.0 ± 5.0g
Material(s) 主要材质	TPU, PC, Leather, Aluminum Alloy TPU, PC, 皮革, 铝合金

[iPhone 16 Pro Max]

Phone Case Dimensions 手机壳尺寸	3.4 × 6.6 × 1.6in 85.8 × 167.0 × 39.4mm
Phone Case Weight 手机壳重量	1.4 ± 0.2oz 40.0 ± 5.0g
Product Weight 产品总重量	2.6 ± 0.2oz 75.0 ± 5.0g
Material(s) 主要材质	TPU, PC, Leather, Aluminum Alloy TPU, PC, 皮革, 铝合金

Manufacturer: Shenzhen Leqi Innovation Co., Ltd.

Add: Rooms 103, 501 and 601, Building 5, Fenghe Industrial Park, Nos. 1301-50 Guanguang Road, Longhua District, Shenzhen, Guangdong, China.

制造商：深圳市乐其创新股份有限公司

地址：中国广东省深圳市龙华区观澜街道新澜社区观光路 1301-50 号丰和工业园厂房 5 栋 103、501、601

Consignor: Shenzhen LC Co., Ltd.

Add: Rooms 602, Building 5, Fenghe Industrial Park, No. 1301-50 Guanguang Road, Xinlan Community, Guanlan Street, Longhua District, Shenzhen, Guangdong, China.

委托商：深圳市乐长科技有限公司

地址：中国广东省深圳市龙华区观澜街道新澜社区观光路 1301-50 号丰和工业园厂房 5 栋 602

执行标准：GB/T 26572-2011

LQ-P1368-18



Made in China

中国制造