

SmallRig

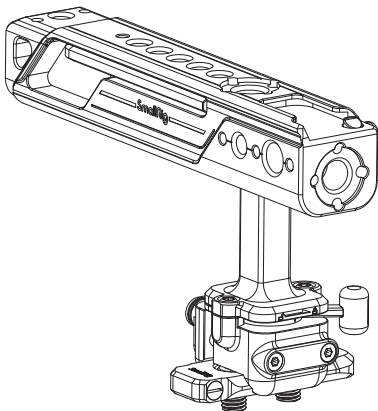

Snap-on NATO Top Handle

User Manual

Thank you for purchasing SmallRig's product.

Warnings

- Please read this User Manual carefully.
- Please heed all warnings and follow all instructions in the owner's manual.

In the Box

Top Handle × 1

NATO Rail × 1

Product Details

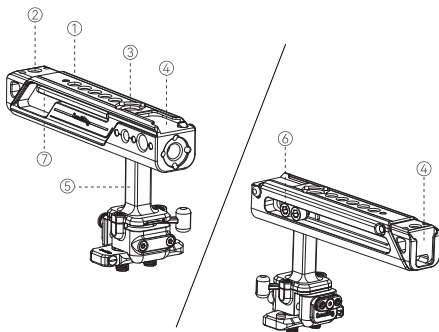

- ① 1/4"-20 Threaded Hole
- ② 1/4"-20 Locating Hole
- ③ ARRI 3/8"-16 Locating Hole
- ④ Cold Shoe Mount

- ⑤ Handle Adapter
- ⑥ M5 Screw
- ⑦ Allen Wrench

Installation Instruction

1. Install the NATO Rail

Step 1: Please attach the NATO Rail to the cage via two 1/4"-20 screws.

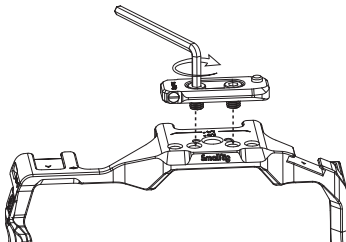

2. Install the Handle to the Cage

Step 1: Push the lever to left to open the lock.

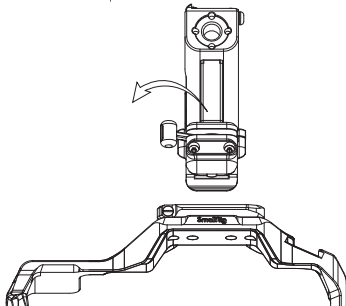

Step 2: Align and press the NATO clamp into the NATO Rail to install.

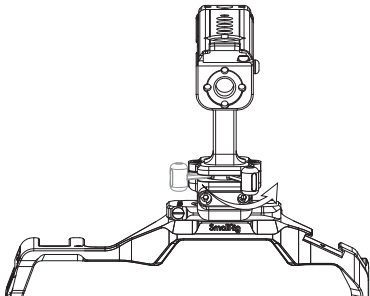

Step 3: Push the lever to the right to secure the handle.

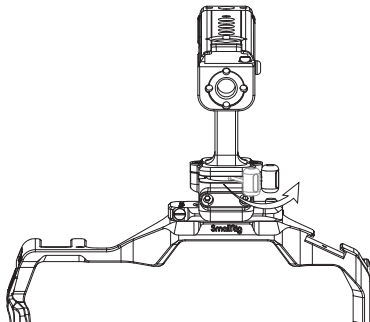

3. Front and Rear Adjustment

Step 1: Loosen the two M5 screws with the included Allen Wrench.

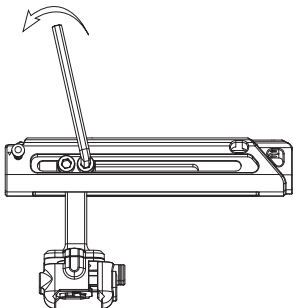

Step 2: After adjusting to the suitable position, tighten the two M5 screws to secure the handle adapter.

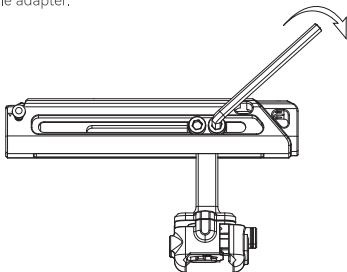

Compatibility

1. NATO Rails: 1/4"-20 threaded holes with 9 or 18mm (0.3 or 0.7 in) distance
2. Handles: Cages and mounting plates, etc. (with NATO rail)

Specifications

Product Dimensions: 134 × 78 × 31.6mm / 5.3 × 3.1 × 1.2in

Product Weight: 204.7 ± 5g / 7.2 ± 0.2oz

Material(s): Aluminum Alloy